



CHAPTER 5

Upgrading the 5-GHz Radio Module

This chapter provides instructions for upgrading a 5-GHz radio module and includes the following sections:

- [Upgrade Overview, page 5-2](#)
- [Removing the 5-GHz Radio Access Cover, page 5-2](#)
- [Removing a 5-GHz Radio Module, page 5-3](#)
- [Installing a 5-GHz Radio Module, page 5-5](#)

Upgrade Overview

This section provides instructions for upgrading the access point 5-GHz radio module (RM21A or RM22A). The following operations summarize the upgrade procedure:

1. Remove all cables and power connections from the access point.
2. Place your access point on a flat surface.
3. For an access point without the 5-GHz radio feature, remove the 5-GHz radio access cover.
4. For an access point with the 5-GHz radio feature, remove the existing 5-GHz radio module.
5. Install the new 5-GHz radio module.

Unpacking the Radio Module

Each 5-GHz radio module is shipped with the following items:

- Quick start guide
- A product registration card
- A T-10 tamper-resistant Torx L-wrench
- A 5-GHz radio compliance label
- A product compliance label (supplied with RM21A and RM22A radio modules)

If anything is missing or damaged, contact your Cisco representative for support.

Removing the 5-GHz Radio Access Cover

On access points without an installed 5-GHz radio module, you must remove the access cover that covers the 5-GHz radio slot. To remove the 5-GHz radio access cover, follow these steps:

-
- Step 1** Remove all cables and power connections from the access point.
 - Step 2** Place the access point on a flat surface so that the unit is upright with the front end facing you.

Step 3 Remove the 5-GHz access cover using the supplied Torx L-wrench (see [Figure 5-1](#)).

Figure 5-1 5-GHz Radio Access Cover

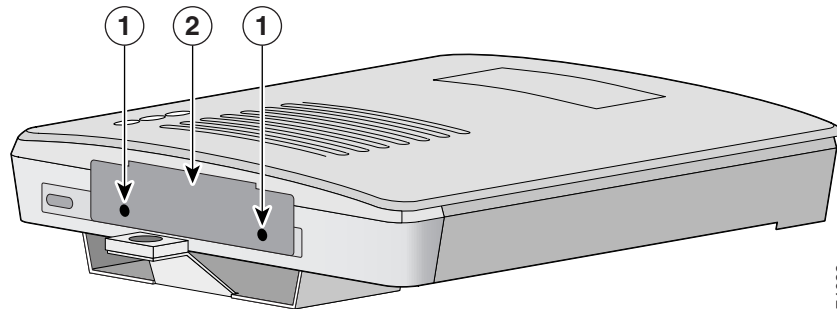

1	Access Cover Screws	2	Access Cover
---	---------------------	---	--------------

Removing a 5-GHz Radio Module

To remove the 5-GHz radio module, follow these steps:

- Step 1** Remove all cables and power connections from the access point.
- Step 2** Place the access point on a flat surface so that the unit is upright with the front end facing you.
- Step 3** Unscrew the two mounting screws using the supplied Torx L-wrench ([Figure 5-2](#)).

Figure 5-2 5-GHz Radio Module

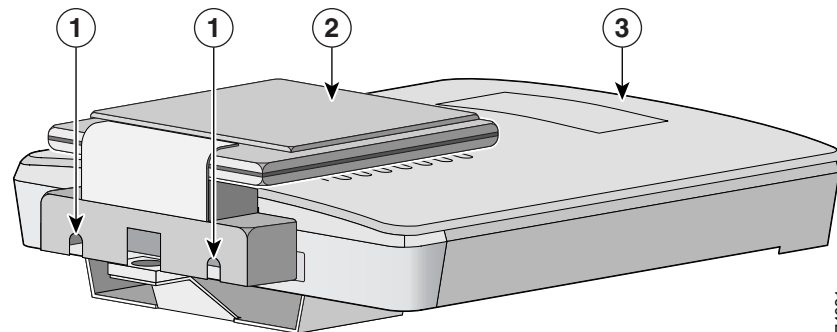

1	Mounting screws	3	Access point
2	5-GHz radio module antenna		



Note Do not attempt to remove the mounting screws from the module; they are captured in the module housing.

- Step 4** Insert your fingers into the base (latch opening) of the 5-GHz radio module (closest to the access point) and pull straight out from the access point (see [Figure 5-3](#)).

Figure 5-3 Removing the 5-GHz Radio Module

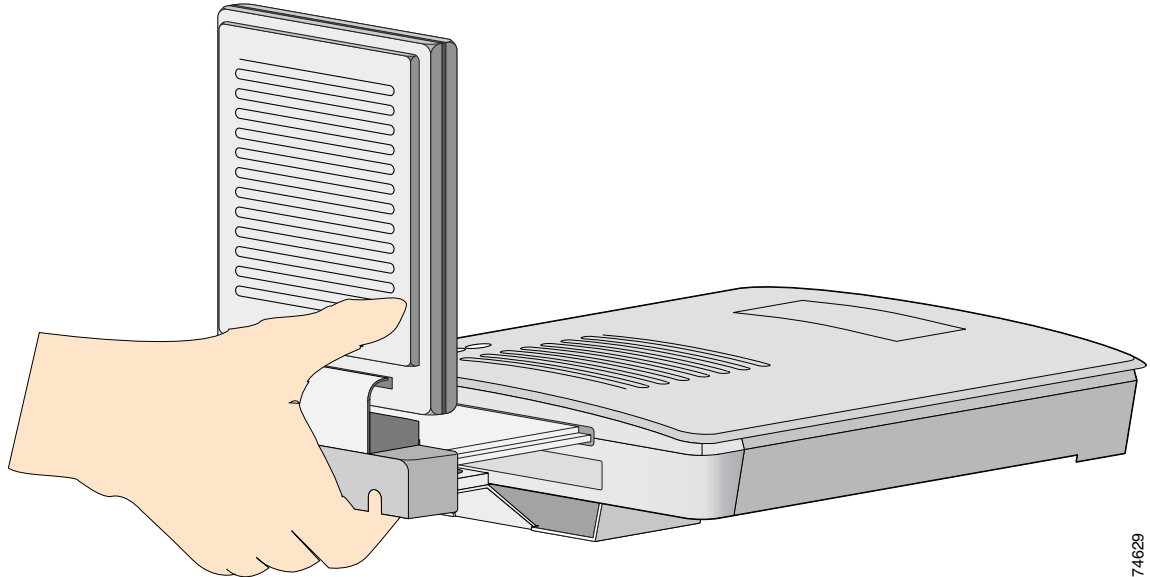

74629

- Step 5** For a radio module with built-in antenna, fold the antenna down (towards the attached radio card) and insert the module into a static protected bag.
- Step 6** For a radio module with connectors, insert the radio module into a static protected bag.
- To install a new 5-GHz radio module, see the [“Installing a 5-GHz Radio Module”](#) section on page 5-5.
-

Installing a 5-GHz Radio Module

To install a new 5-GHz radio module (RM21A or RM22A) into your access point, follow these steps:

- Step 1** Before you can install a new 5-GHz radio module, you must remove the access cover or an existing 5-GHz radio module (refer to “[Removing the 5-GHz Radio Access Cover](#)” or “[Removing a 5-GHz Radio Module](#)”).
- Step 2** Place the access point on a flat surface so that the unit is upright with the front end facing you.
- Step 3** Grasp the new 5-GHz radio module by its base (with the latch opening point down or the antenna pointing up) and insert the card into the access point’s card-bus slot (see [Figure 5-4](#)).

Figure 5-4 Installing a 5-GHz Radio Module (RM20A or RM21A Shown)

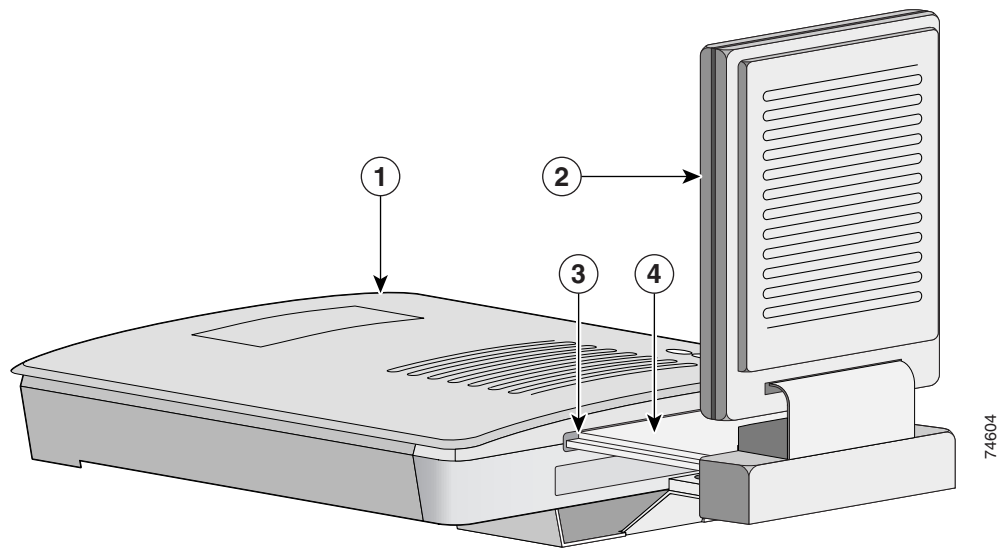

1	Access point	3	Access point card-bus slot
2	5-GHz radio module antenna	4	5-GHz radio card

- Step 4** Push the 5-GHz radio module into the slot until you hear a slight click.

Step 5 Tighten the 5-GHz radio module mounting screws using the supplied Torx L-wrench (see [Figure 5-5](#)).

Figure 5-5 Location of Mounting Screws (RM21A) Shown

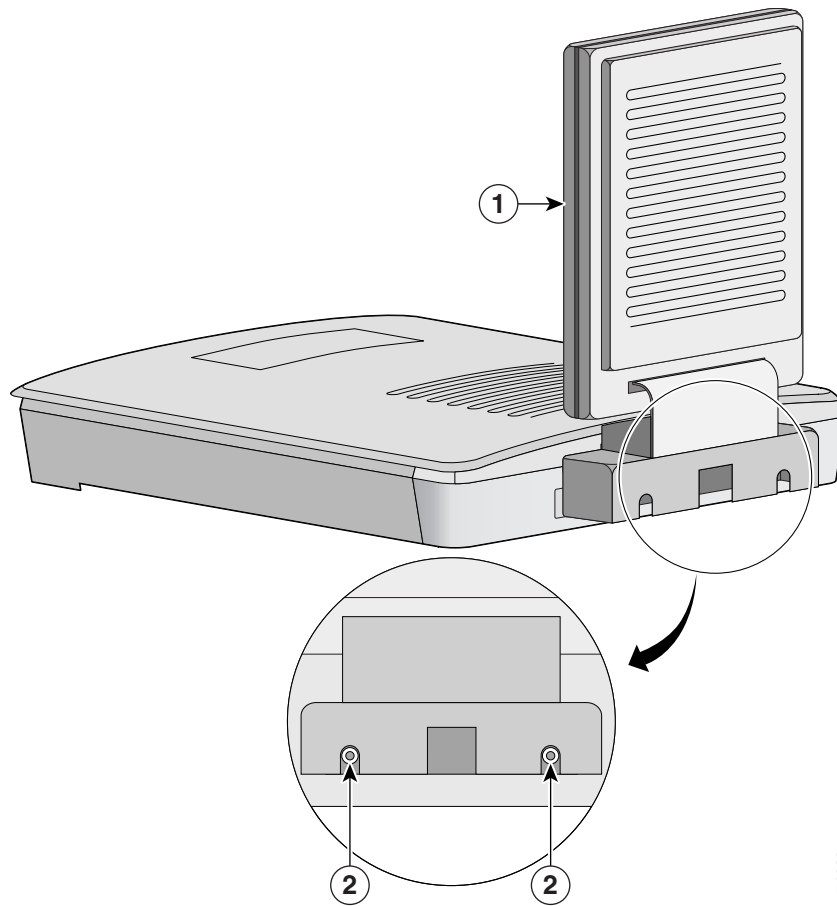

1	5-GHz radio module antenna	2	Mounting screws
----------	----------------------------	----------	-----------------

Attaching the Compliance Label

There are three places on the 1200 series access point dedicated to compliance labels, one for the product compliance label and two for the radio compliance labels. The label locations are shown in [Figure 5-6](#).

Figure 5-6 Access Point Compliance Label Locations

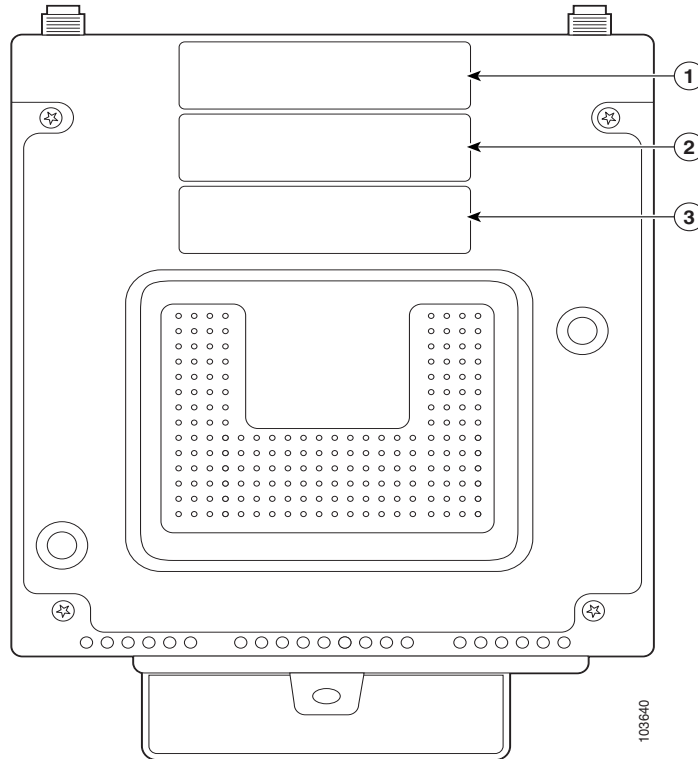

1	Product compliance label	3	Radio compliance label
2	Radio compliance label		

The product compliance label always occupies the top space (location 1). The two spaces below the product compliance label (locations 2 and 3) contain the radio compliance labels. Whether or not locations 2 or 3 contain labels depends on how your access point is configured. For example, the access point could have two radio compliance labels (one for each radio device installed), or the access point could have only a product compliance label, depending on how it was ordered.

Make sure that your access point has the correct labels after you install or upgrade its radio configuration so that it will be in compliance with regulations in your country.

The AIR-MR21A and AIR RM22A radio upgrade kits ship with the following labels for the 1200 series access points:

- 1200 series product compliance label (AIR-AP1210-x-K9)
- 1200 series radio compliance label (AIR-RM21A-x-K9 or AIR-RM22A-x-K9)

[Table 5-1](#) shows where to place the labels on your 1200 series access point, based on the model you are upgrading. Follow these steps to place the labels correctly:

- Step 1** Check the product compliance label to identify the model number of your 1200 series access point.
- Step 2** Refer to [Figure 5-6](#) for the compliance label locations.
- Step 3** Use the matrix in [Table 5-1](#) to decide which labels to use and where to place them on the access point.

Table 5-1 *Locations for Compliance Labels*

1200 Series Model	AIR-RM21A-x-K9 or AIR-RM22A-x-K9 Radio Compliance Label	AIR-AP1210-x-K9 Product Compliance Label
AIR-AP1220A	Place over existing AIR-RM20A-x-K9 radio compliance label or location 3 if no label exists.	Place over existing product compliance label.
AIR-AP1230A		
All other models		Discard product compliance label.

- Step 4** Discard any labels that you did not use.

The 5-GHz radio module installation is now complete and radio settings are at default values. To configure the 5-GHz radio with your wireless network settings refer to the *Cisco IOS Software Configuration Guide for Cisco Aironet Access Points*.