

Cisco Smart+Connected Advanced Node



The Cisco Smart+Connected Advanced Node and video sensors provide actionable data from high definition video, and are an integral part of the Smart+Connected Lighting Solution—an open architecture-based light-sensory network that can be deployed along with LED luminaires.

This high-performance node supports high-bandwidth data and contains a powerful computational engine for analyzing data-rich applications. It also fully supports local high-intensity analysis of HD video for applications such as security, smart parking, and traffic analytics.

Features and Benefits

Main Features

- Dual 720p video sensor support
- Dedicated video analytics processor
- Video storage of 256GB
- POE (Power over Ethernet) port provides power to additional devices
- RTSP streaming available (requires viewing application)
- Powered by the Core Node on the LED or a Video Node Connector Cable that connects the advanced node directly to the light pole power line.

Communication and Security

The Advanced Node features highly-secure, certification-based authentication for every device using TLS 128-bit encryption. Communication to the device uses standard 802.11 a/b/g/n wireless communication protocols. Two 5GHz, 2.4dBi antennae are included.

Video Sensors

Two QMA connector ports are available for mounting up to two 1.2M pixel video sensors.

Mounting

Horizontal and vertical pole mounts (for round and square poles) are included. See the mounting specifications for more information.

Power

Default way to power the Cisco Advanced Node is through the Cisco Core Node through a nector connector.

Alternatively, a video connector kit for the video node to be powered directly from the pole's power source is available. There are 2 options to connecting through this kit:

- Option 1: From inside the luminaire (slides 9 - 10)
- Option 2: From an outdoor rated adaptor enclosure (slides 11 - 12)

See the recommended cut-out specifications for a visualization.

Dimensions

The following figures display the device dimensions (in millimeters).

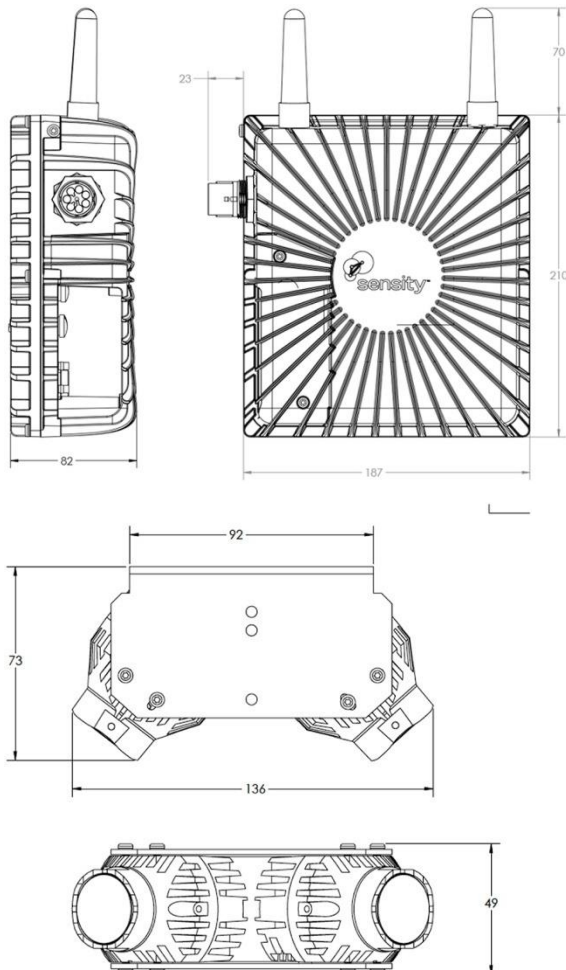

Product Specifications

Table 1. Advanced Node Specifications

Specification	Description
Video Resolution	Selectable 360p and 720p
Frame Rate	Up to 30fps
Video Storage	Up to 256GB
Input Voltage	120-277V or 480V
Max. Power Consumption (no auxiliary power)	18W for 120-277V 20W for 480V
Max. Weight (includes video sensor)	120-277V config: 9 lbs. 480V config: 10.5 lbs.
Dimensions (Video Node)	11.5" x 8.5" x 4.0"
Dimensions (Video Sensor Module)	5.4" x 2.9" x 1.9"
Color	Gray
POE Support	POE+ (802.11at)
Operating Temperature	-30C to 55C

Table 2. Mounting Specifications

The horizontal and vertical pole mounts are available in the following configurations:

Mounting Type	Horizontal Pole Mount	Vertical Pole Mount
Round Pole Diameter	1 5/8" - 2 3/8"	Minimum 3"
Square Pole Dimension	Minimum 4" height	Minimum 3" width

Recommended Cut-Outs for the Video-Connector Kit in the Pole:

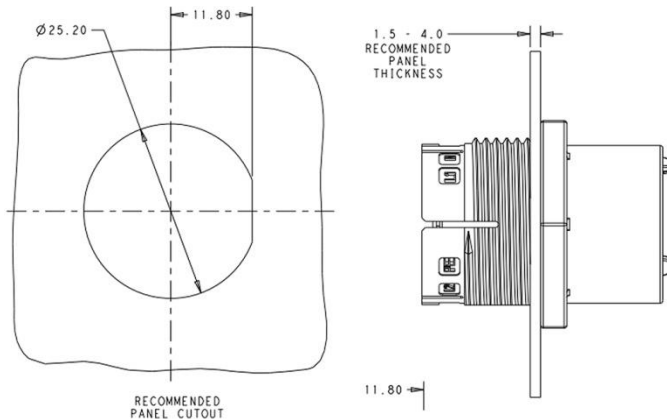

Warranty Information

For information on Sensity product and services, including warranty information or returns, please contact Sensity directly at:

Email: RMA@SENSITY.COM

Phone: (855) 500-SENS

Web: <http://www.sensity.com>

If a product must be returned for repair or replacement, you must obtain a Return Material Authorization (RMA) number from Sensity.

Note: Customer shall return the Product at Customer's expense within 30 days of receiving instructions for return. Failure to follow the return instructions shall void warranty. Customer will package equipment in a manner that is (i) in accordance with good commercial practice, (ii) acceptable to common carriers for shipment at the lowest rate for the particular equipment, and (iii) adequate to ensure safe arrival of the equipment at the named destination.

Ordering Information

The following table lists the currently available Smart+Connected Lighting Solution products.

Table 3. Ordering Information

Product Name	Part Number	Quantity in Bundle
Starter Kit		
Advanced Node Starter Kit, WiFi, 120-277V, 256GB Storage	SCS90-052056-256AK	1
Advanced Node		
Advanced Node WiFi, 120-277V, 256GB Storage with mounting brackets	SCS90-052-VN-256AK	1
Advanced Node WiFi (ROW), 120-240V, 256GB Storage, with mounting brackets	SCS90-079-VN-256W=	1
Advanced Node WiFi, 480V, 256GB Storage with mounting brackets	SCS90-055-VN-256WK	1
Video Sensor Kit		
Dual Video Sensor With Linear View Mounting Kit, Wide Forward Tilt	SCS90-056-DVS-LV=	1
Accessories		
Video Node Connector Cable	SCS95-116-VN-CKA=	1
Power Cable (North America), Core Node to Video Node, 4ft, 120- 277V	SCS95-070-AC-VNA=	1
Power Cable (ROW), Core Node to Video Node, 1.2m, 120- 277V	SCS95-074-AC-VNW=	1
Power Cable (North America), Core Node to Video Node, 2ft, 120- 277V	SCS95-099-AC-VNA=	1
Power Cable (ROW), Core Node to Video Node, 0.6m, 120- 277V	SCS95-101-AC-VNW=	1
T-Splitter for Power Cable, 120-277V	SCS95-080-AC-SPTA=	1
T-Splitter for Power Cable, 480V	SCS95-090-AC-SPTW=	1
Power Cable (North America), Core Node to Video Node, 4ft, 480V	SCS95-071-AC-VNA=	1
Power Cable (North America), Core Node to Video Node, 2ft, 480V	SCS95-100-AC-VNA=	1
Cable, RT Angle, Cat 6A, M12 to RJ45, 3 Meters	SCS95-097-AC-C3M=	1
Cable, RT Angle, Cat 6A, M12 to RJ45, 5 Meters	SCS95-098-AC-C5M=	1

Cisco Capital

Financing to Help You Achieve Your Objectives

Cisco Capital can help you acquire the technology you need to achieve your objectives and stay competitive. We can help you reduce CapEx. Accelerate your growth. Optimize your investment dollars and ROI. Cisco Capital financing gives you flexibility in acquiring hardware, software, services, and complementary third-party equipment. And there's just one predictable payment. Cisco Capital is available in more than 100 countries. [Learn more.](#)

For More Information

For more information about the Cisco Smart+Connected Lighting Solution, visit:

http://www.cisco.com/web/strategy/smart_connected_communities/city-lighting.html.



Americas Headquarters
Cisco Systems, Inc.
San Jose, CA

Asia Pacific Headquarters
Cisco Systems (USA) Pte. Ltd.
Singapore

Europe Headquarters
Cisco Systems International BV Amsterdam,
The Netherlands

Cisco has more than 200 offices worldwide. Addresses, phone numbers, and fax numbers are listed on the Cisco Website at www.cisco.com/go/offices.

Cisco and the Cisco logo are trademarks or registered trademarks of Cisco and/or its affiliates in the U.S. and other countries. To view a list of Cisco trademarks, go to this URL: www.cisco.com/go/trademarks. Third party trademarks mentioned are the property of their respective owners. The use of the word partner does not imply a partnership relationship between Cisco and any other company. (1110R)