



Cisco Universal VESA Mount Installation Instructions for Cisco Virtualization Experience Client 6215

The Cisco Universal VESA Mount allows you to mount the Cisco Virtualization Experience Client 6215 (Cisco VXC 6215) on a wall or on most VESA-compliant mounting surfaces. The VESA Mount supports both 2.95 in. (75 mm) and 3.94 in. (100 mm) mounting patterns. The mounting bracket consists of two identical pieces. One piece attaches to the mounting surface with user-provided hardware that can withstand a force of 35 pounds (15.88 kg), and the other piece attaches to the thin client. After the bracket pieces are joined with four thumb screws, the thin client is in an upright position. You can attach cables to the thin client at any convenient time, as long as the power is disconnected.



Caution

Cisco does not recommend that you mount the Cisco VXC 6215 on a monitor.



Note

Be aware of the following installation notes:

- When you determine the location for mounting, take into account the cable lengths of the monitor, keyboard, mouse, power supply, and peripherals.
 - Mount the thin client only as indicated; improper orientation (where the back panel or front panel is facing down) can disrupt the cooling of heat from the device and damage it.
 - Leave at least 0.49 in. (12.5 mm) between the ventilation holes of the thin client and any solid surface. An enclosed area must have a minimum of 23.25 square in. (150 square cm) of venting above and below the thin client (a total minimum of 46.5 square in. [300 square cm]) to maintain proper ventilation of the thin client.
-

Use the following instructions to mount the thin client:



Americas Headquarters:
Cisco Systems, Inc., 170 West Tasman Drive, San Jose, CA 95134-1706 USA

© 2012 Cisco Systems, Inc. All rights reserved.

Procedure

- Step 1** Remove the four filler screws from the thin client, and keep them in a safe place for use in Step 2.

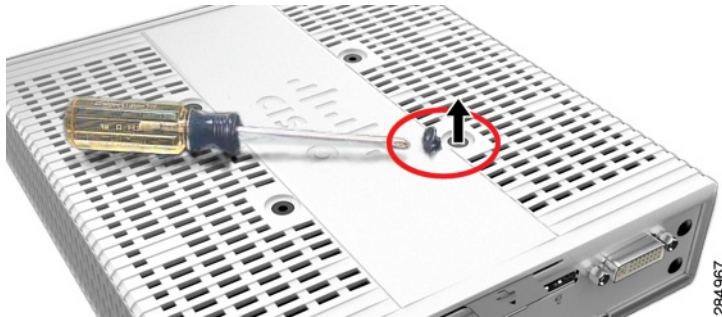

- Step 2** Position one bracket piece on the thin client as shown to match a set of mounting holes, with the turned edge on top (pointing downward). Secure the bracket with the four filler screws from Step 1 (do not overtighten).

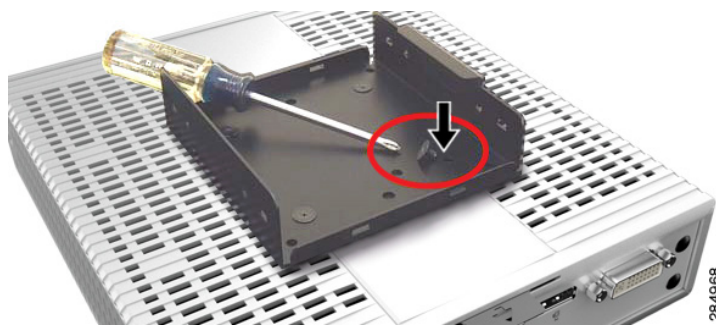

- Step 3** Place the power supply on the bracket that is attached to the thin client, with the AC power cord facing the front of the thin client and DC cord facing the back panel.



Step 4 Attach the second bracket piece to the mounting surface, with the slotted end on top and the turned edge at the bottom (pointed upward). The mounting surface (a swing arm mount is shown) can have either the VESA 2.95 in. (75 mm) or 3.94 in. (100 mm) mounting pattern. If the mounting surface is a pole, stud, or beam, use the center vertical or horizontal mounting holes. Secure the bracket with proper user-provided hardware that can withstand a force of 35 pounds.



Note If you are installing the VESA Mount on a hollow wall, you can use any standard anchoring method, such as screws, butterfly anchors, or expansion bolts.



Step 5 Face the thin client bracket toward the mounted bracket. Hold the thin client bracket a little higher than the mounted bracket, and then slide it downward to have the turned edges drop into slots at both top and bottom.



Step 6 Line up the screws holes of the bracket pieces (two on top and two on bottom) and secure with the four thumb screws that are provided (do not overtighten).



Step 7 Use tie wrap to secure the power cord and DC cord at any of the small slots.



Step 8 (Optional) Install a key lock for security to any one of the four Kensington lock slots (two located on top and two on bottom).



Step 9 Attach the cables to their respective connectors on the back panel of the thin client.