

AI Assistant in Cisco Business Dashboard

Objective

The objective of this article is to provide an overview of the new AI Assistant on the Cisco Business Dashboard (CBD).

Applicable Devices | Software Version

- Cisco Business Dashboard | 2.10.1

Introduction

CBD is designed to simplify network management for small and medium-sized businesses. With the latest update, CBD 2.10.1, a new AI Assistant has been added that is set to transform how you find information and manage your Cisco Business network.

The AI Assistant in CBD acts as your go-to resource for quick, accurate answers to your questions about Cisco Business products and CBD using Cisco's Circuit AI.

Key Capabilities and Benefits of AI Assistant

- **Instant Access to Information:** No more sifting through manuals or searching online. The AI Assistant can quickly retrieve information from official Cisco documentation.
- **Comprehensive Knowledge Base:** The AI Assistant is trained on a vast library of Cisco Business documentation, including:
 - Admin Guides
 - Quick Start Guides (QSG)
 - Data Sheets
 - Installation Guides
 - CLI Guides
 - Release Notes
 - Tech Notes
 - Frequently Asked Questions (FAQs)
 - Even videos from Cisco Tech Talks!
- **Wide Product Coverage:** It supports queries across popular Cisco Business product lines, such as:
 - Catalyst 1200/1300 Series Switches
 - CBS 250/350 Series Switches
 - CBS 220 Series Switches
 - Cisco Business Wireless (CBW) Access Points
 - Cisco Business Dashboard (CBD) itself

- Cisco Business Mobile App

Pre-requisites

- Both the CBD system and the client's management system must have internet access and can reach the Amazon Web Services url (<https://smb-ai.cbd-aws.com/ai/app/index.html>)
- Additionally, a Cisco.com (CCO) account is required for authentication

Launching AI Assistant

Step 1

To launch the AI Assistant, log in to your CBD.



Log in

Email

Next

[Unlock account?](#)

[Help](#)

Don't have an account? [Sign up](#)

Step 2

Select the new AI Assistant icon in the upper righthand corner of the CBD window.

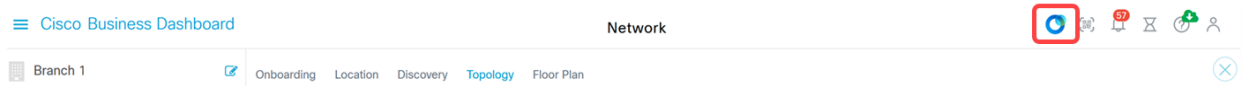

Step 3

You will be prompted to enter your Cisco credentials.



Log in

Email

☐ Remember me

Next

[Unlock account?](#)

[Help](#)

Don't have an account? [Sign up](#)

Step 4

Once you have entered your credentials, it will either run the Welcome to the AI Assistant page (the first time you sign into that dashboard's AI assistant) or it will navigate directly to the AI Assistant.

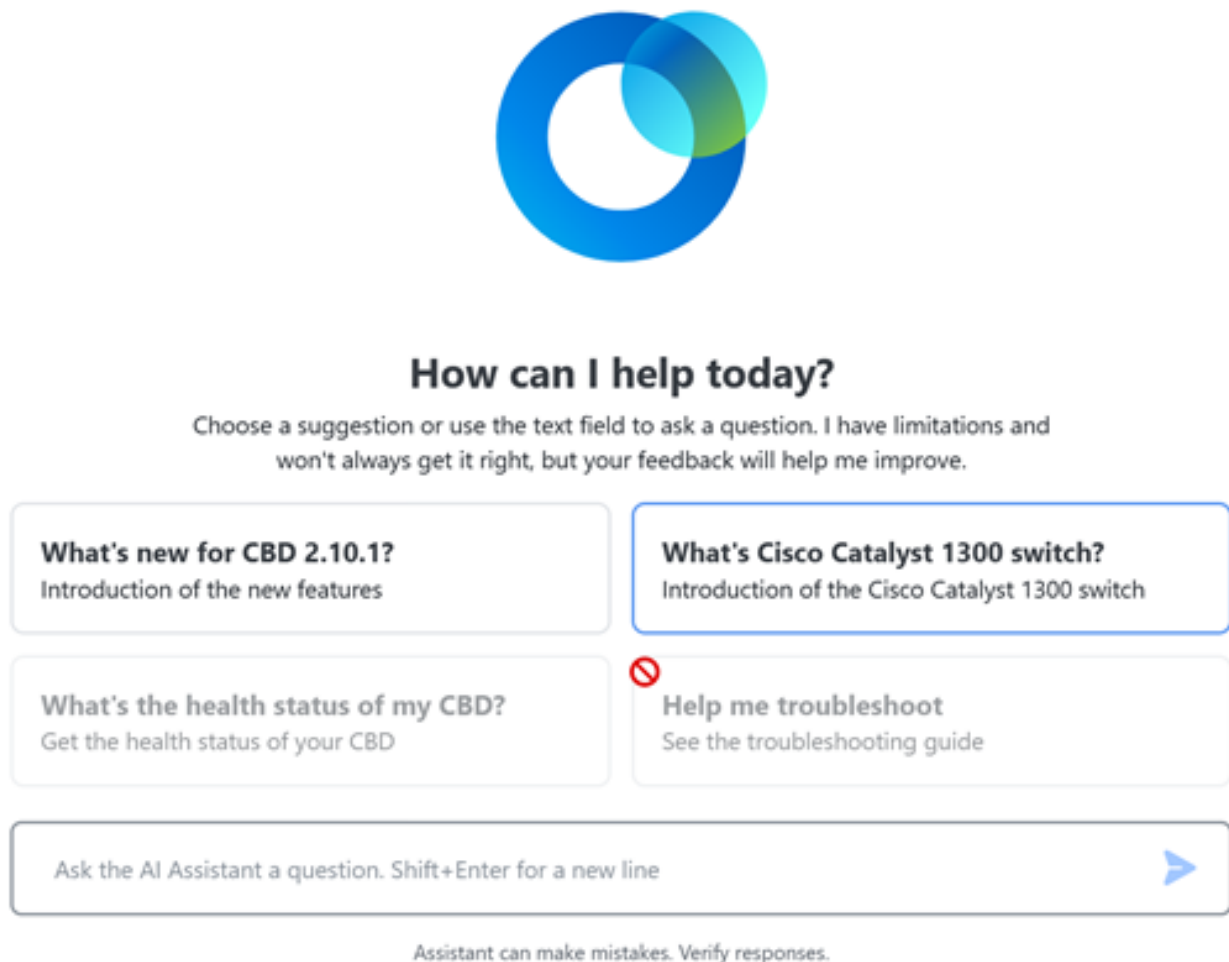

The screenshot shows the AI Assistant interface. At the top is a large blue circular logo with a green and blue gradient. Below it is the heading "How can I help today?" followed by a disclaimer: "Choose a suggestion or use the text field to ask a question. I have limitations and won't always get it right, but your feedback will help me improve." There are four suggestion boxes: "What's new for CBD 2.10.1?" (Introduction of the new features), "What's Cisco Catalyst 1300 switch?" (Introduction of the Cisco Catalyst 1300 switch), "What's the health status of my CBD?" (Get the health status of your CBD), and "Help me troubleshoot" (See the troubleshooting guide). The "Help me troubleshoot" box has a red prohibition icon. At the bottom is a text input field with the placeholder "Ask the AI Assistant a question. Shift+Enter for a new line" and a blue arrow button. Below the input field is a disclaimer: "Assistant can make mistakes. Verify responses."

Step 5

By default, the AI Assistant will appear as a popup over the CBD browser window.

- 1 In the upper lefthand corner of the screen is the collapse thread history option.
- 2 Immediately below is the new thread button and the thread history. The new thread starts a new query string, and the thread history shows the queries that this user has issued against the AI.
- 3 In the upper righthand corner is the control bar.
- 4 At the bottom of the screen is the query field to input questions or refine questions in the same thread.

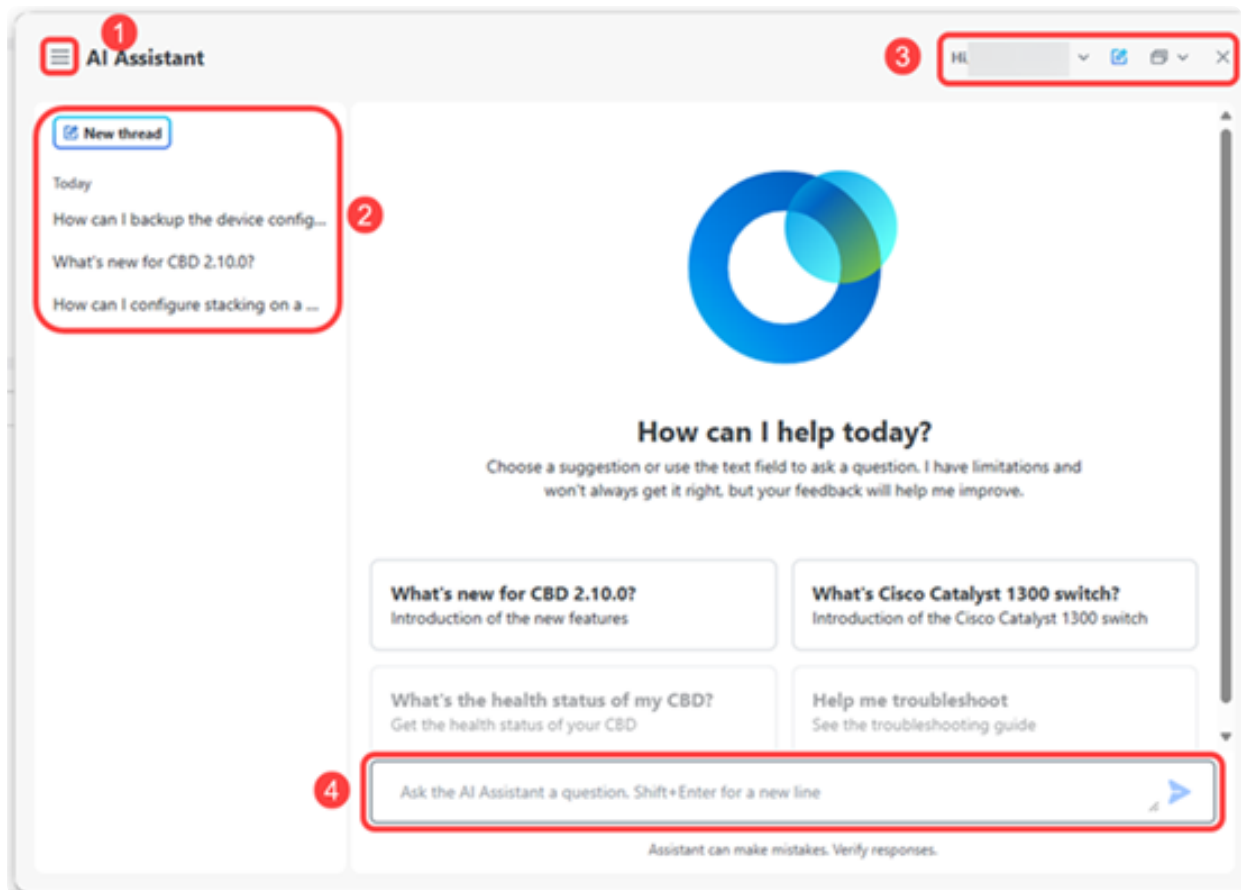

Step 6

The control bar in the upper right-hand corner of the screen has several controls:

- It will display the username and there is a dropdown to log out of the AI instance.



- A shortcut to open a new query thread.

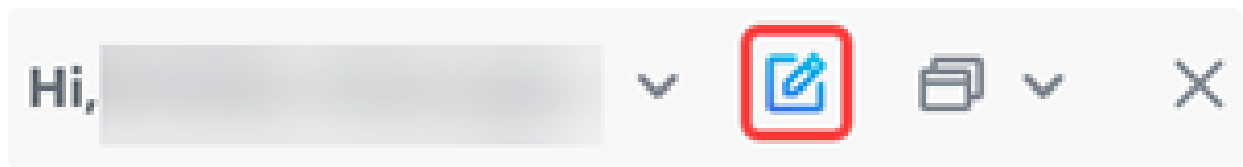

- There is a window control that allows you to switch the AI window to a docked view on the right side of the screen, the default floating window, or open as a full screen.

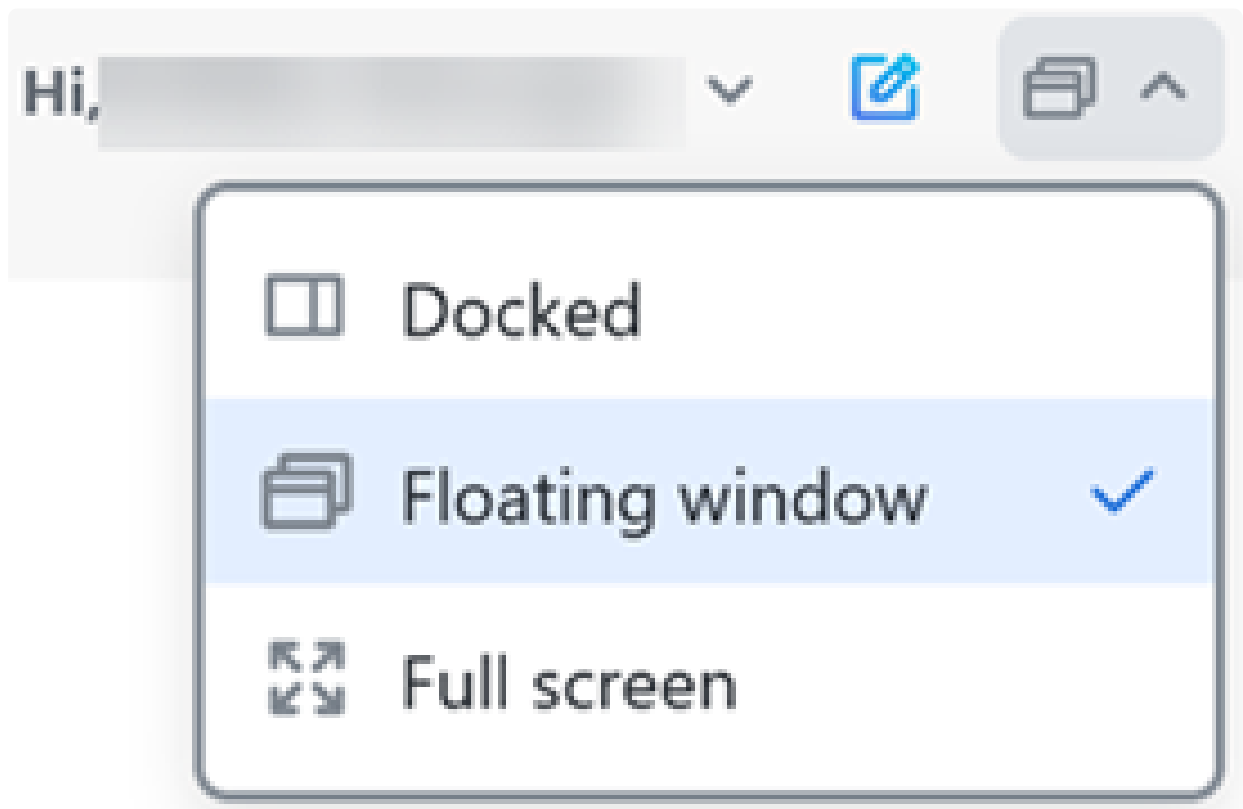

- A close window option.

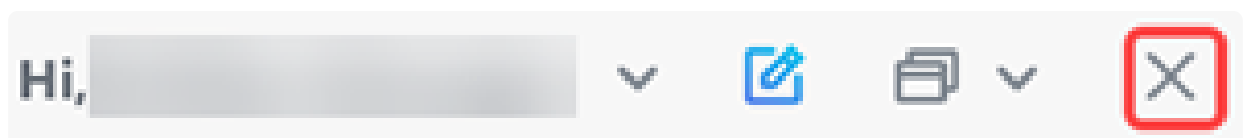

AI Assistant Query Example

An example of a query using the AI Assistant is shown here. It provides links to the sources that the AI used to find the data.

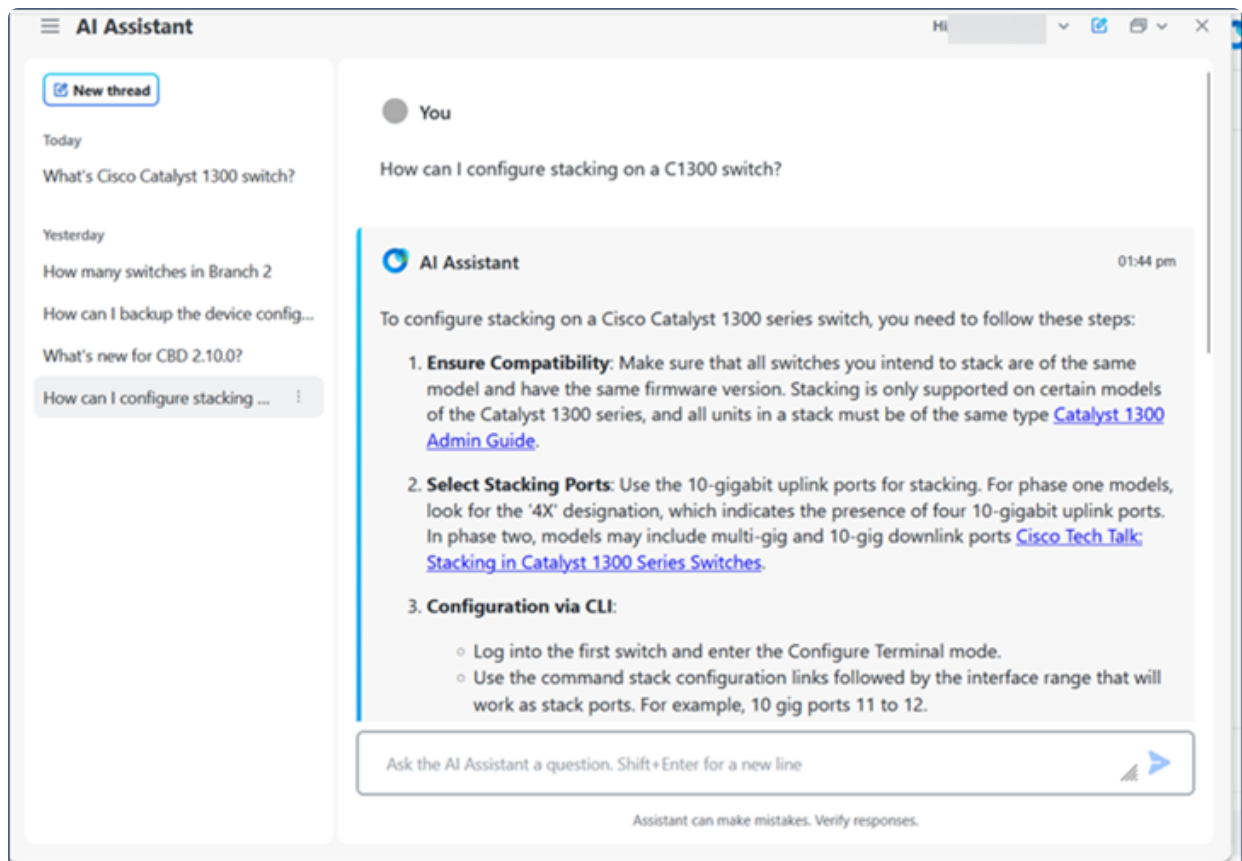

Conclusion

The AI Assistant in CBD is a significant step towards making network management even more intuitive and efficient. Explore this new feature and experience the power of AI-driven support!