

Cisco Board Pro Series



Earthquake security kit installation

Follow the installation instruction in the [Cisco Board Pro G2 – Floor Stand and Wheel Base Installation Guide](#)

Install the earthquake security kit in combination with steps 6-7.

Maximum wire length: 3 m/9.84 ft

Due to the size and mass of the product, it is important that security kit parts are securely fixed to the ceiling by qualified personnel. Follow current building regulations.

Due to the variety of ceiling constructions, the installer must determine the number and type of screws required for a safe installation. The installer has to bring the parts that are required to fix the product securely to the ceiling.

If you're adding the kit to a Board Pro that has already been installed, remove the rail covers first.

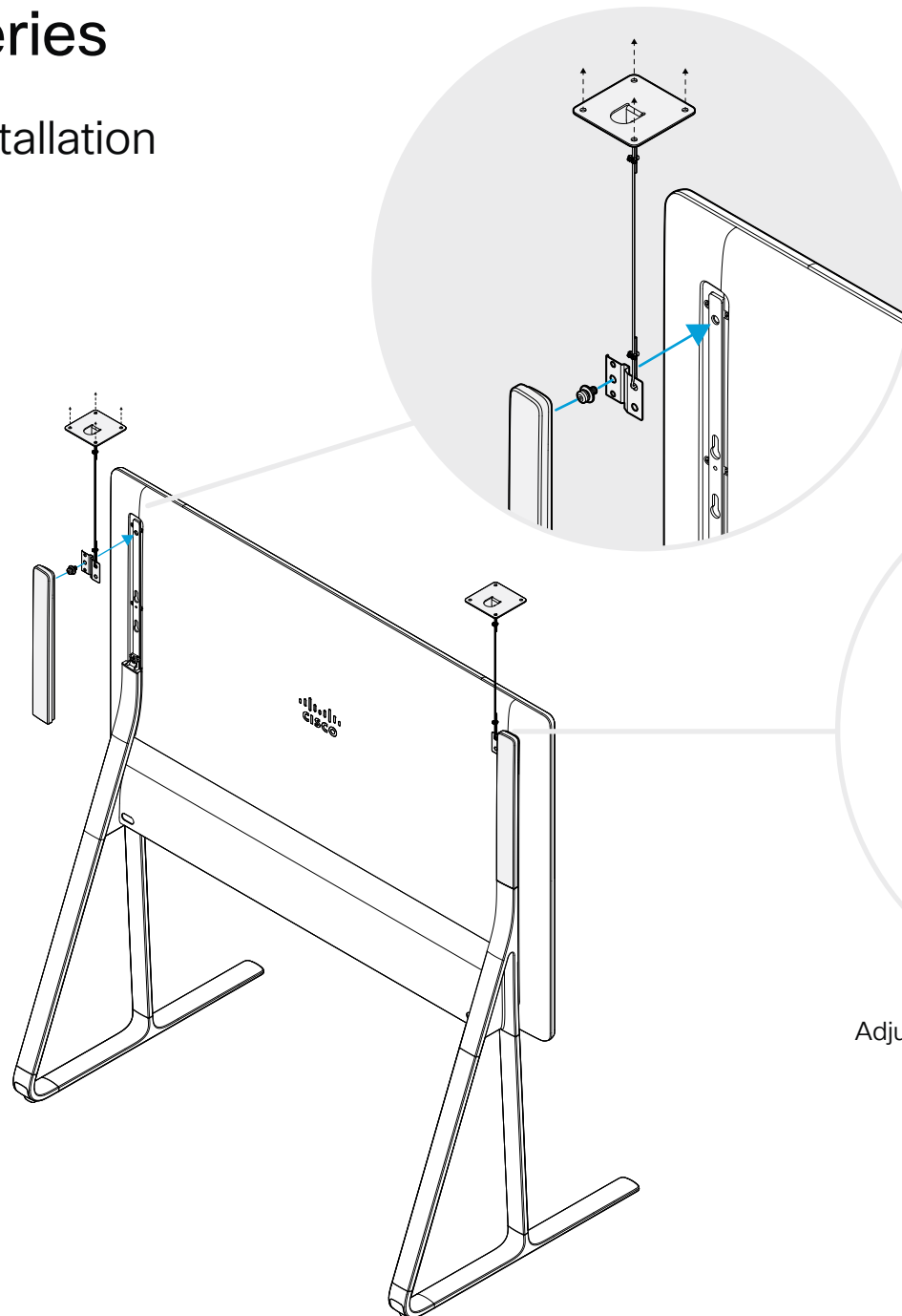
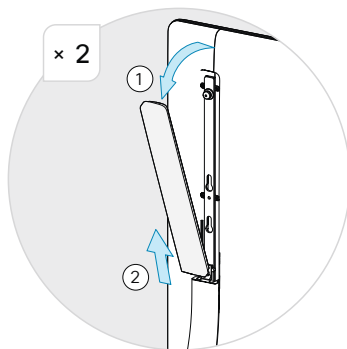

Adjust the wires so that they are not loose.