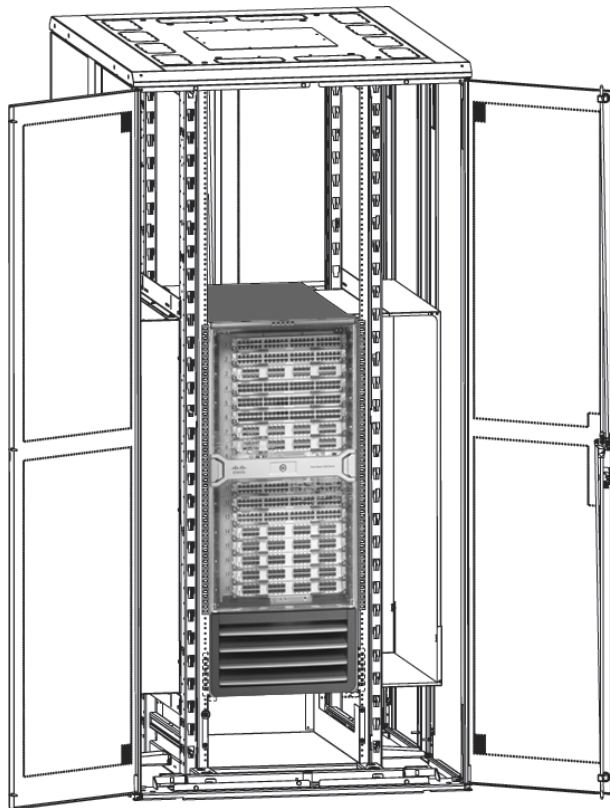
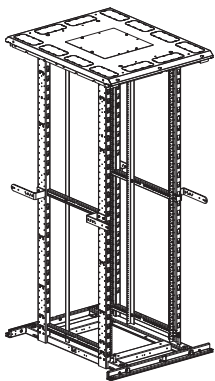
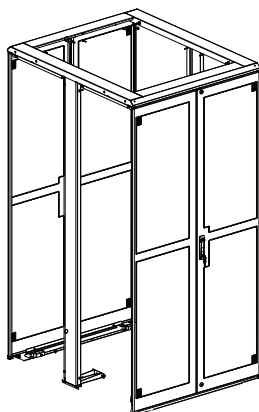

INSTRUCTIONS CM385

© Panduit Corp. 2008

Component Guide

CN3

- (1) Base Cabinet
- (2) Cable Management Finger Kits
- (1) Hardware Kit
- (2) #12-24 Threaded Equipment Rail Sets

CN7018-EXT

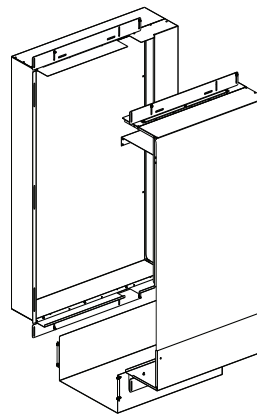
- (2) Top Side Extensions
- (2) Top Front/Rear Extensions
- (2) Bottom Door Shoe Extensions
- (2) Bottom Side Extensions
- (2) Split Door Sets
- (2) Vertical Side Supports
- (1) Hardware Kit

CNAE7018

- (1) Inlet Duct Assembly
- (1) Exhaust Duct Assembly
- (1) Bottom Duct Assembly
- (5) Mounting Brackets
- (1) Hardware Kit

CNPS7018

- (2) Side Panels
- (2) Lower Horizontal Supports

 For installation instructions for the CN3 cabinet, please reference instruction sheet **CM317B**.

Top Cap Extension Assembly

Installation of Top Side Extensions

Install (2) top side extensions, using (2) 5/16" serrated flange lock nuts on each extension (there are pre-installed 5/16" press-studs in side extensions). Remove knock-out feature from original top cap if necessary. Do not tighten side extensions until front and rear extensions are mounted and aligned with original top cap. Top front and back extension installation is shown at the bottom of this page.

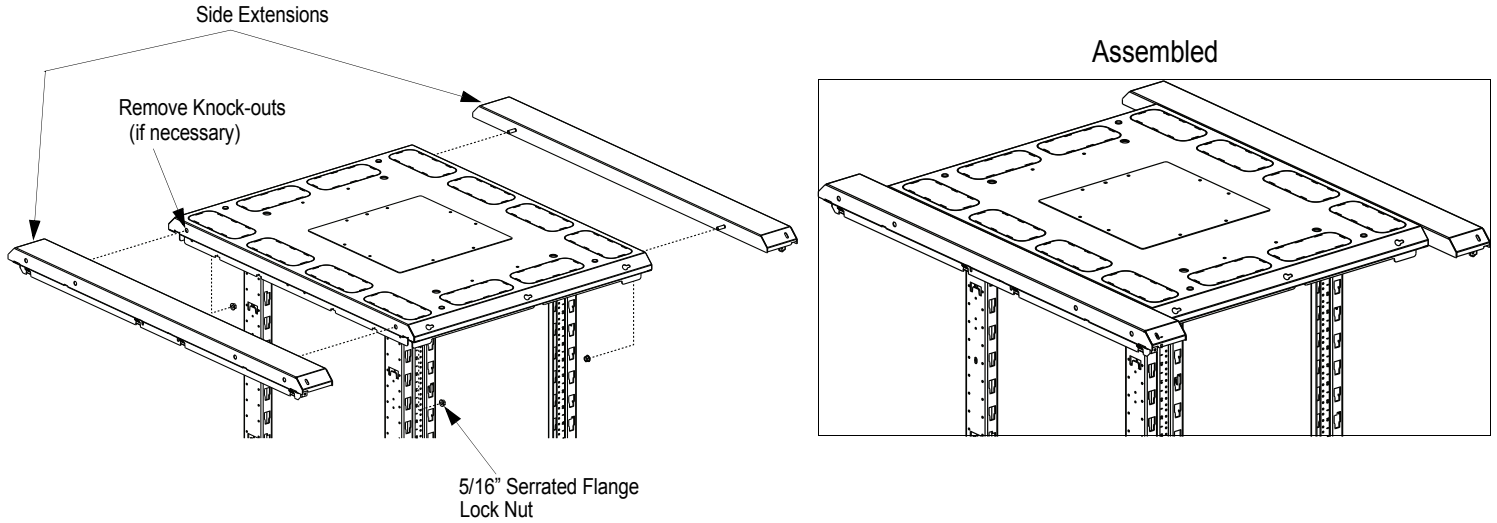

Installation of Top Front and Back Extensions

Attach (2) top front and rear extensions, using (4) #10-32 nuts and (4) #10 lockwashers per extension piece (there are (4) pre-installed #10 press-studs in each extension). Align all top extension parts, leaving a minimal gap between side and front/rear parts. Secure side extensions by tightening (4) 5/16" serrated flange lock nuts.

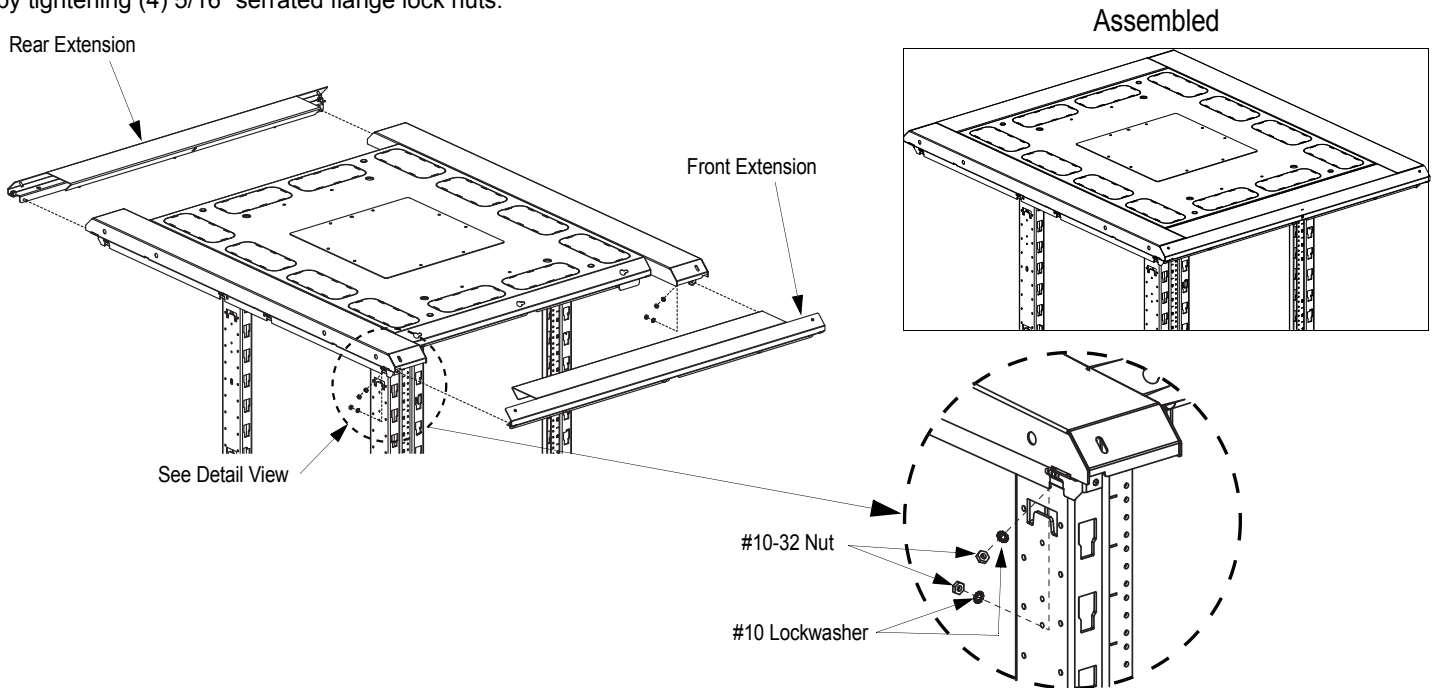

Door Shoe Extension Assembly

Installation of Front and Back Bottom Door Shoe Extensions

Install (2) door shoe extensions to existing cabinet door shoes using (6) #12-24 pan head phillips screws on each side and (6) #12 lockwashers; (4) screws vertical on front and (2) screws horizontal from behind. Center extension by installing a screw through the centering hole first, followed by installing the remaining screws through slots as shown.

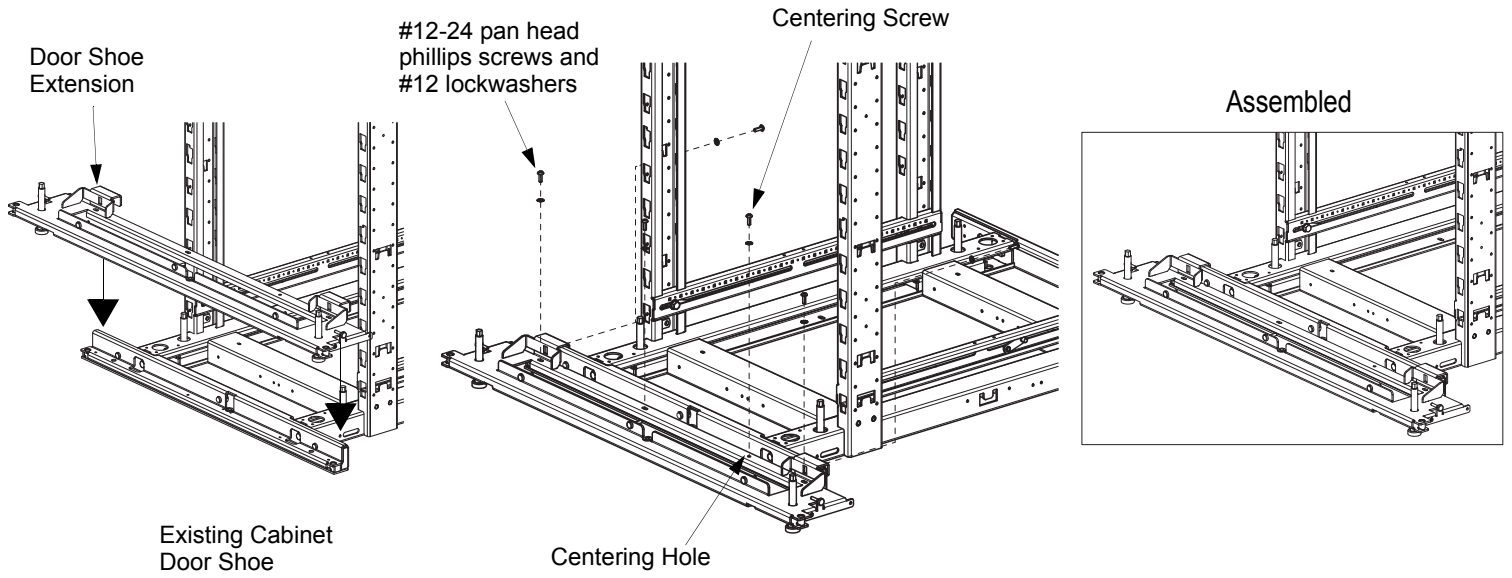

Installation of Bottom Side Extensions

Install (2) bottom side extensions as shown. Secure using (2) #12-24 serrated hex head screws on each extension.

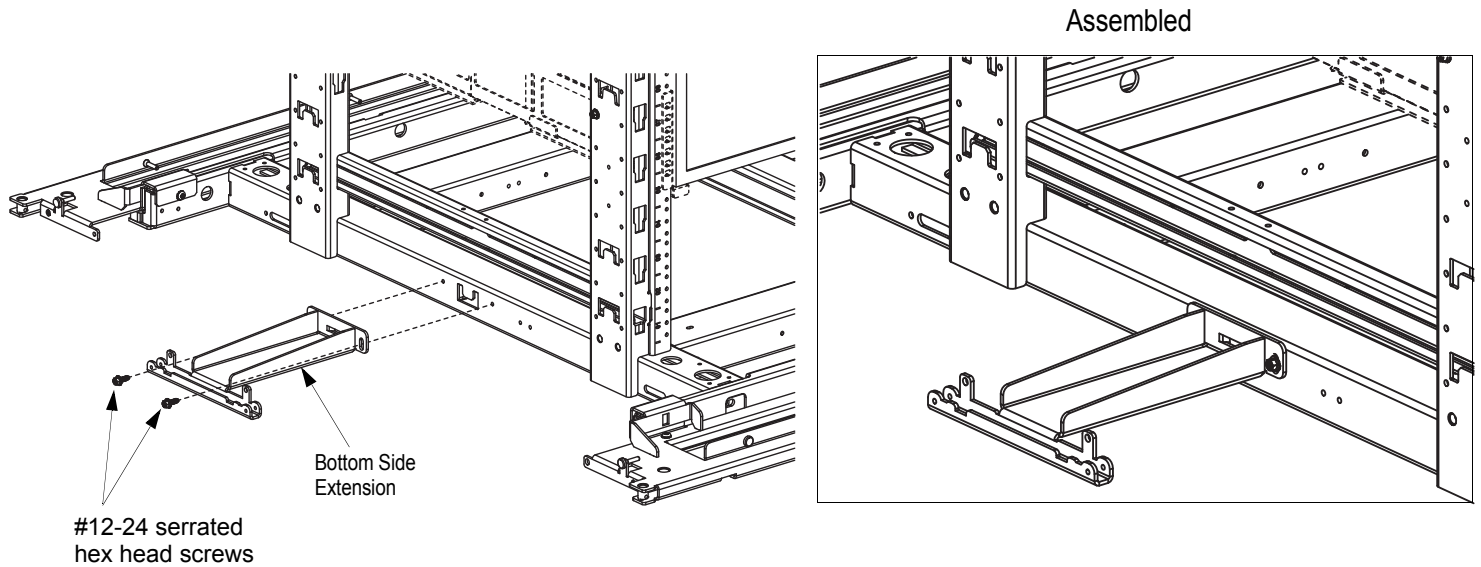

Exhaust Duct Installation

Install (2) universal ducting brackets on the top and bottom surfaces of the exhaust duct using (6) #10-32 pan head phillips screws and (6) #10 lockwashers. Mount duct assembly to cabinet posts using (7) #12-24 serrated hex head screws through ducting brackets and slotted flange as shown. The top flange of duct assembly should be positioned above the top surface of switch.

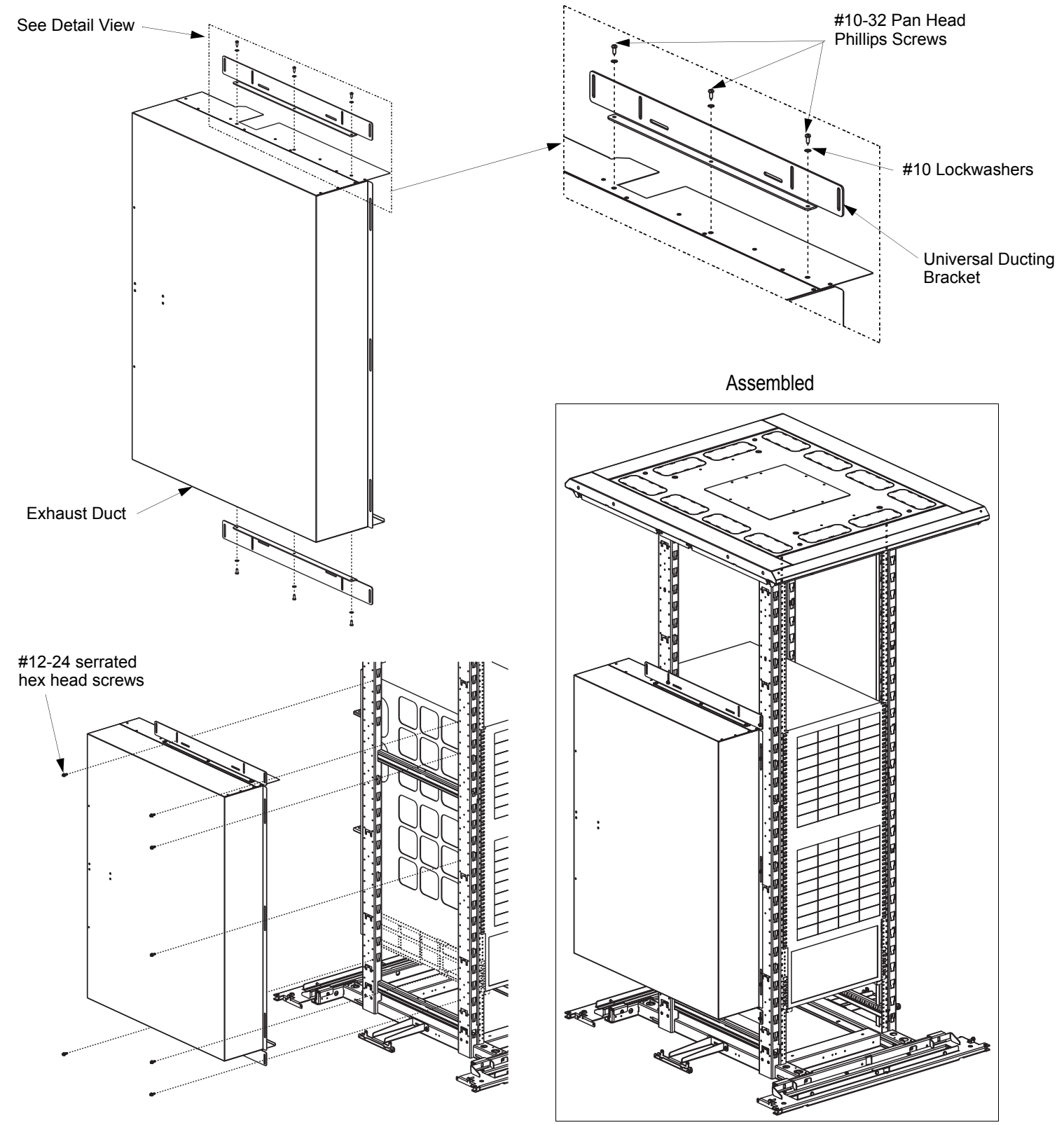

Inlet Duct and Bottom Duct Installation

Install (2) universal ducting brackets on the top and bottom surfaces of the inlet duct using (6) #10-32 pan head phillips screws and (6) #10 lockwashers. Mount inlet duct assembly to cabinet posts using (4) #12-24 serrated hex head screws through ducting brackets as shown. The top flange of duct assembly should be positioned above the top surface of switch. Mount bottom duct to equipment rails using (4) #12-24 serrated hex head screws as shown. Attach rear mounting bracket to bottom duct using (2) #10-32 hex nuts and (2) #10 lockwashers (there are (2) pre-installed press studs on the bottom duct). Secure the bracket to rear equipment rails using (2) #12-24 serrated hex head screws as shown.

NOTE: if using bottom duct, loosen (2) wing nuts inside inlet duct assembly and fully extend the bottom flange. Mount inlet duct assembly to cabinet posts in the same manner listed above.

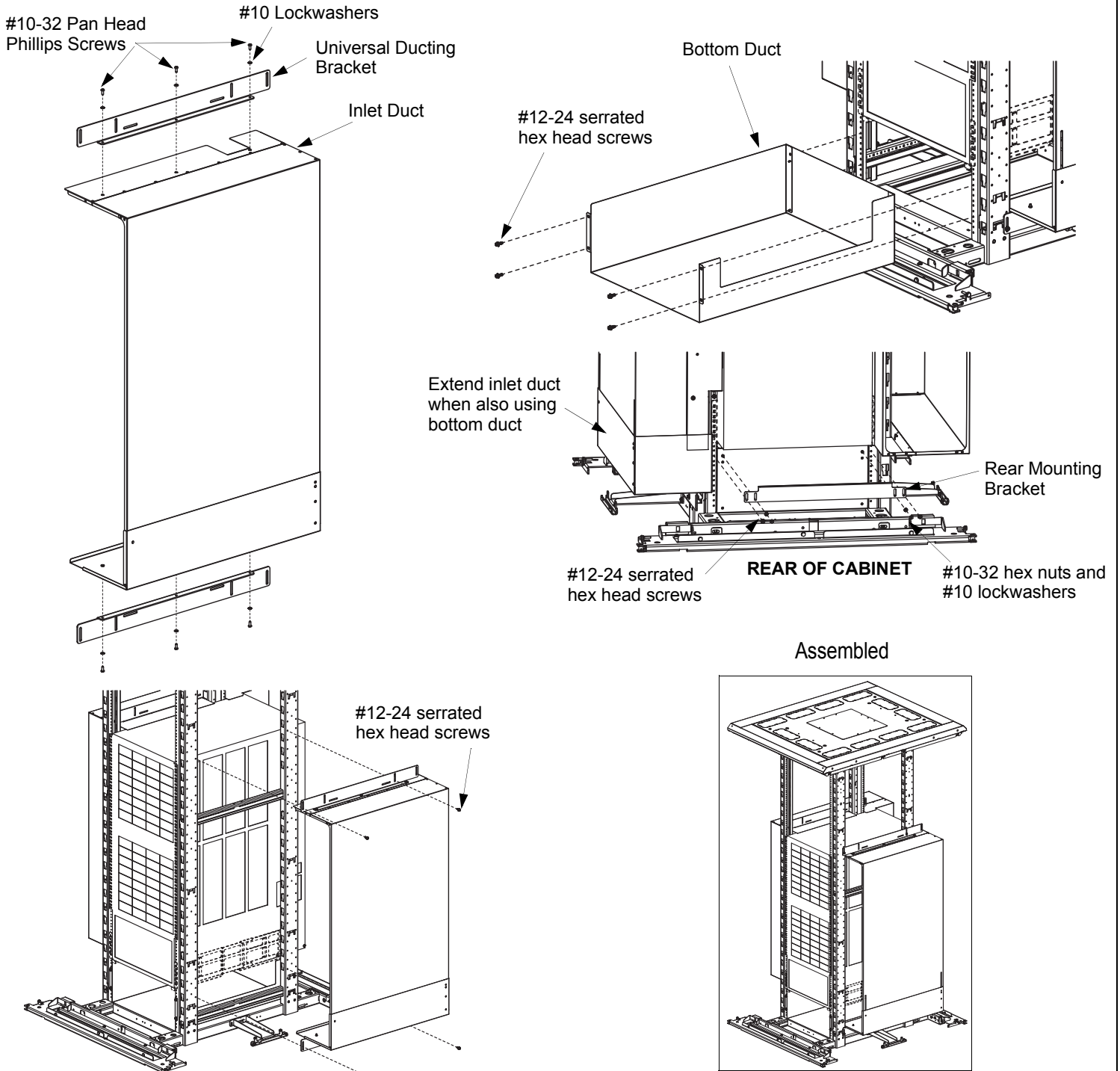

Vertical Side Support Installation

Mount (2) vertical side supports using (4) #10-32 nuts per post; (2) at top and (2) at bottom (there are (4) pre-installed press studs in each post).

Vertical Side Supports

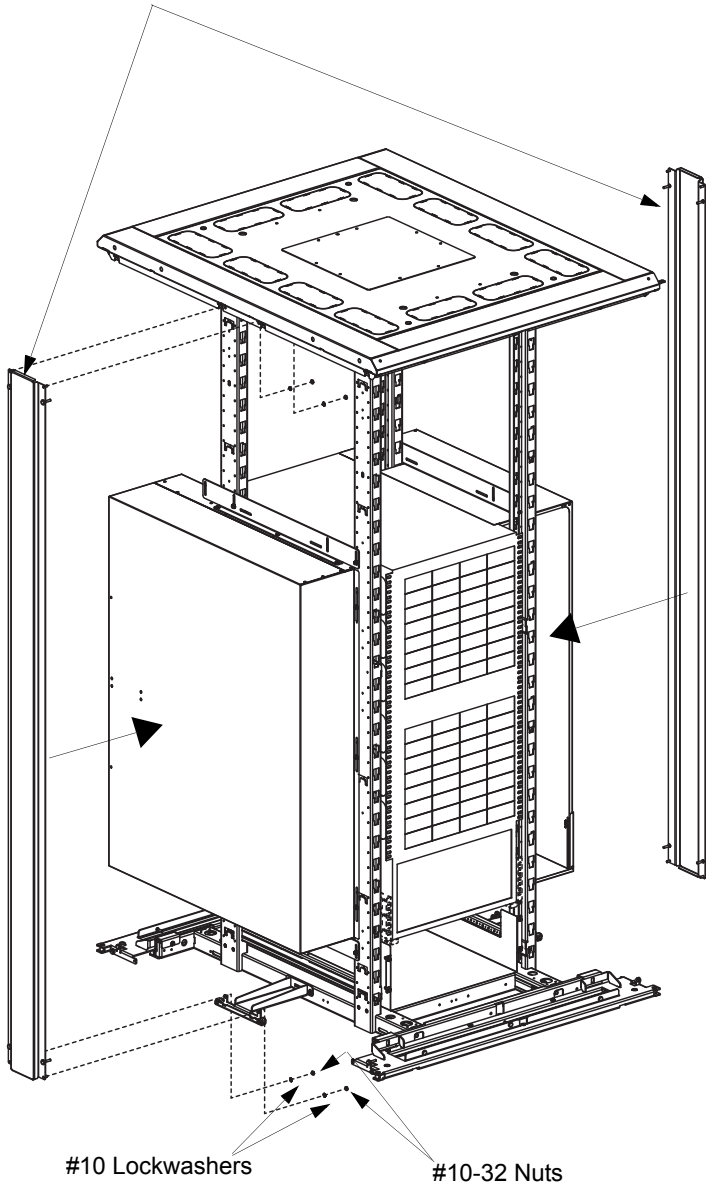

Assembled

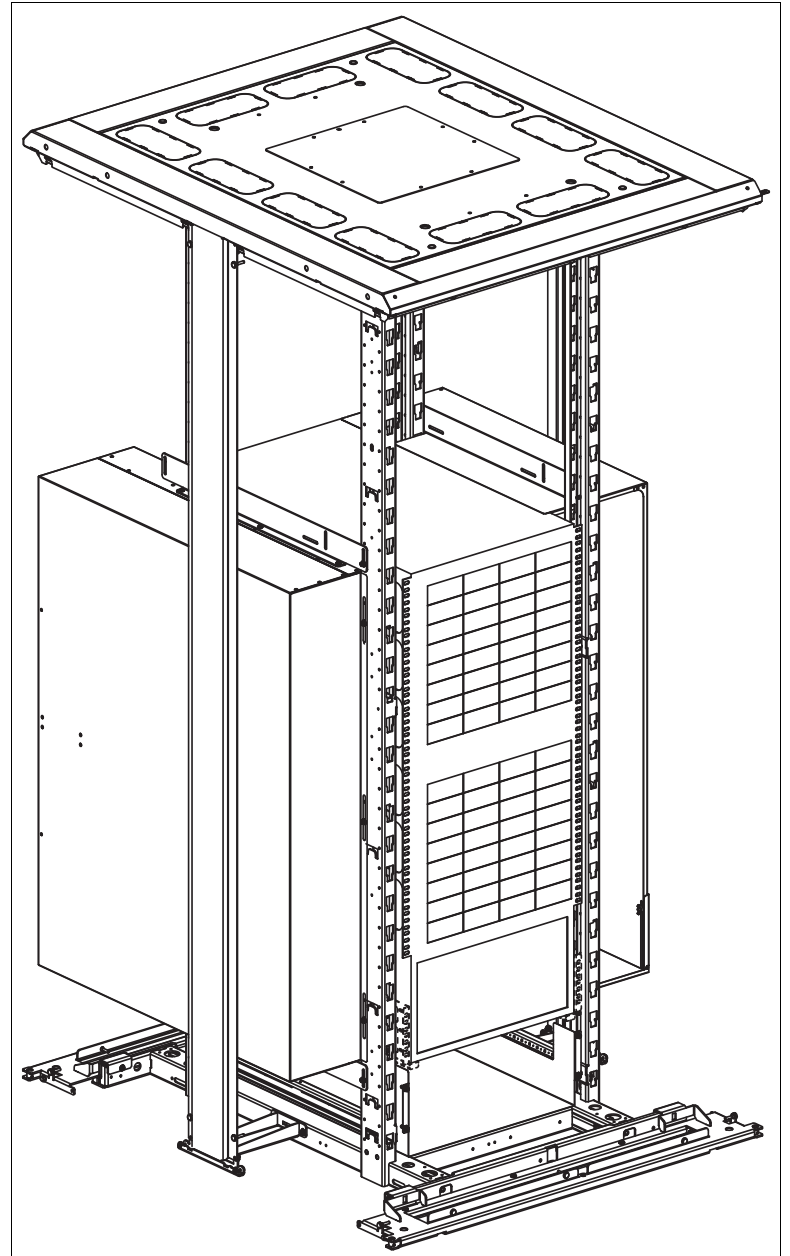

Side Panel Installation

Installation of Lower Horizontal Supports

Mount (4) lower horizontal supports, using (2) #10-32 flat head screws and (2) #10 lockwashers (at bottom side extension) and (1) 1/4-20 hex head screw (at door shoe extension) per lower horizontal support as shown.

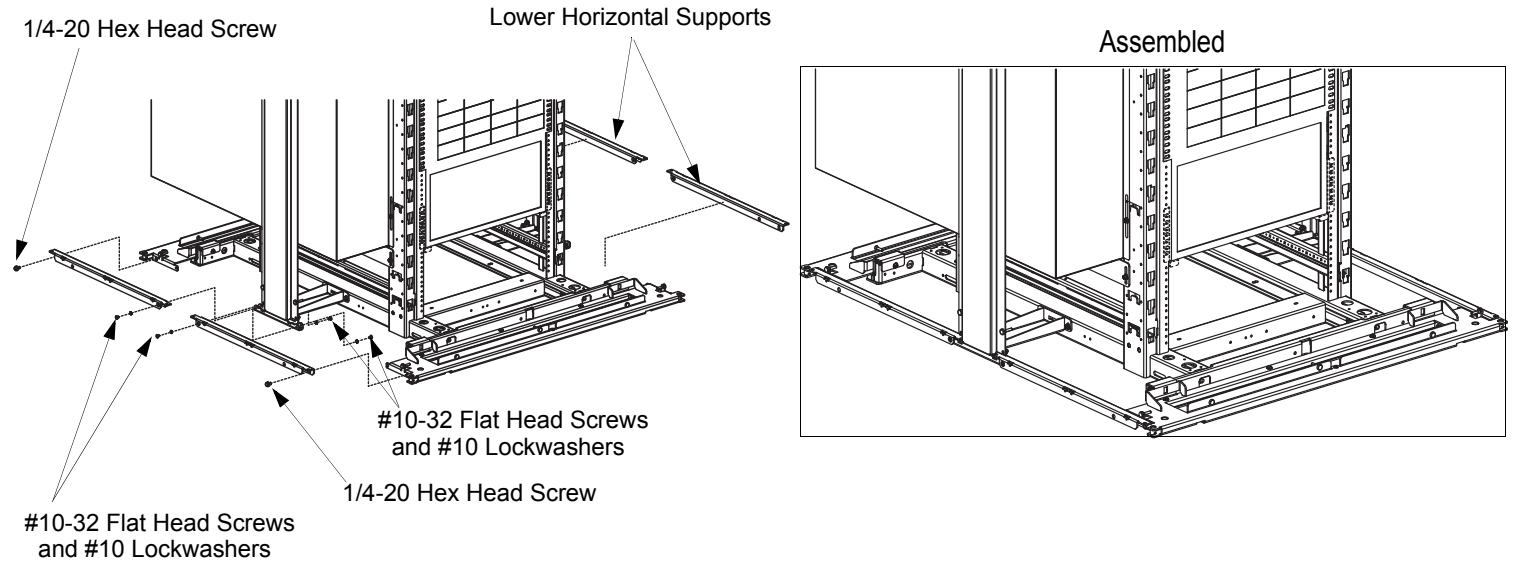

Installation of Side Panels and Split Doors

Side Panels

Pull down the lever of the top spring loaded hinge pin and lock into position. Lift side panel and align bottom pin with the hinge point in the lower horizontal support. Swing door up and align pin with the hinge point in top cap extension. Release locked hinge pin lever. Pull and lock remaining spring loaded hinge pins and move side panel into position. Release levers when aligned. Reverse steps to remove side panels.

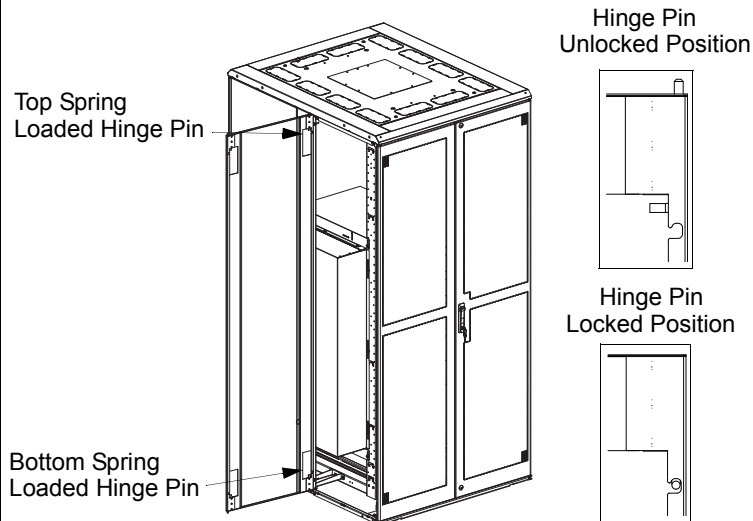

Split Doors

Lift split door and align fixed hinge pin with the bushing in the bottom door shoe extension. Swing door up and pull down the lever of the spring loaded hinge pin and align pin with the bushing in top cap extension. Release lever when aligned. Reverse steps to remove door.

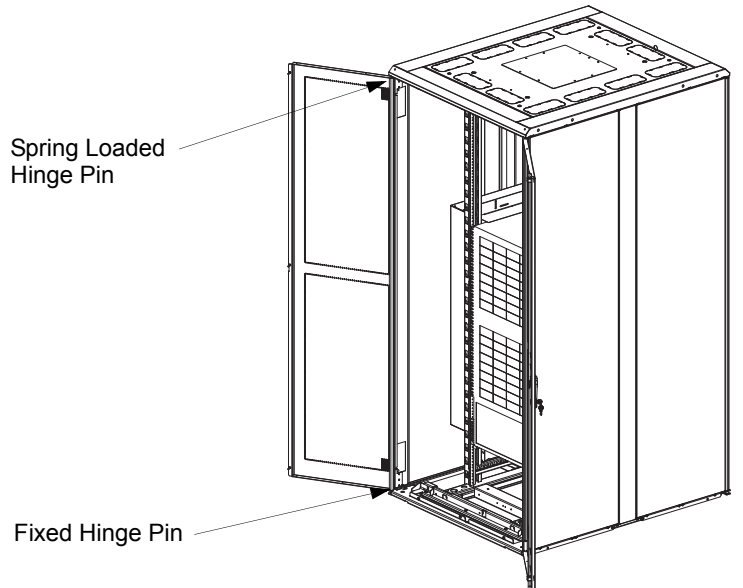

Adjustment of Side Panel

Adjust side panels by loosening the (2) hex head screws securing the bottom side extension to the cabinet frame as shown. Reposition the bottom side extension as necessary. Tighten the (2) hex head screws.

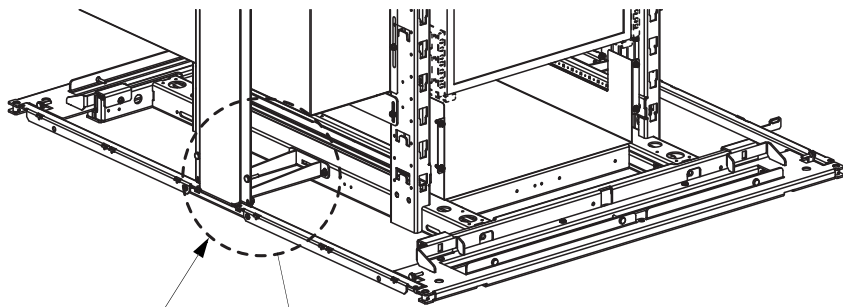

See Detail View

Loosen these screws

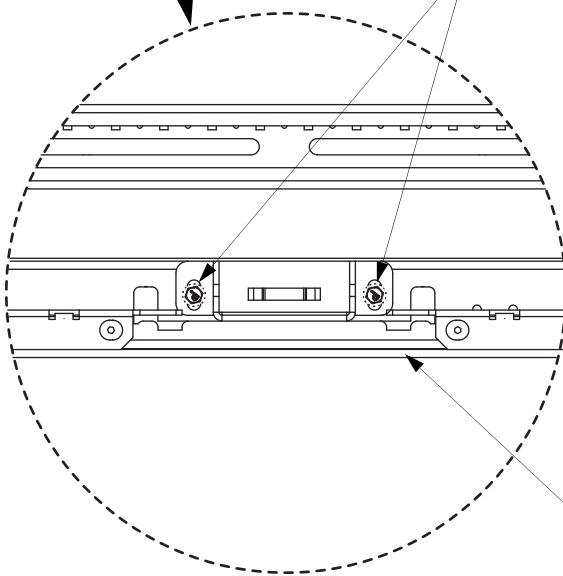

Reposition Bottom Side Extension as necessary

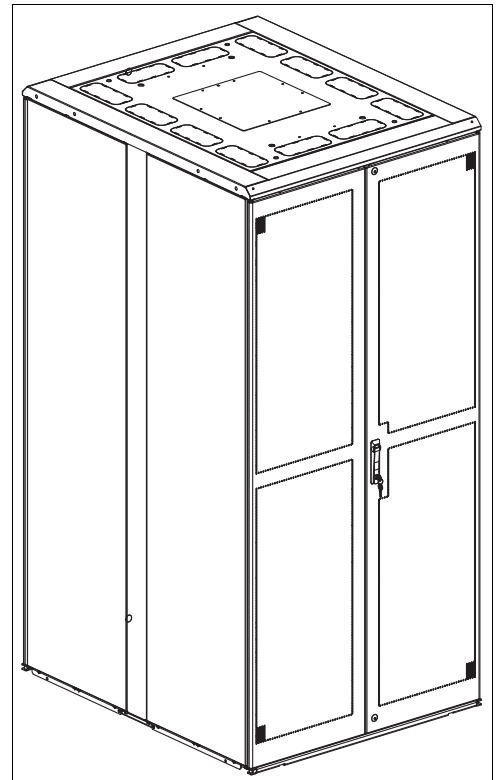

For Instructions in Local Languages
and Technical Support:

www.panduit.com/resources/install_maintain.asp



E-mail:
cs@panduit.com
Fax:
(708)444-6448