

Home Automation



to enable the future



WAVES: The Home in your Hand

How do you imagine your home in a next future? Not too difficult to guess, it's likely that you expect more comfort, security, entertainment, and - of course - automation.

Telsey has this same belief and is working to make the home of the future a reality introducing its new Home Automation system.

The Telsey Home Automation system is a unique solution that integrates the "traditional" domotic applications with the innovative services that are made available by the broadband networks. And all the functions can be controlled by a portable Terminal where an easy to use interface can guide the user through all the available features.



In a hand, the user can take control of:

- > Video Entry System
- > Video Surveillance
- > Alarm System
- > Lights
- > Temperature
- > Electrical Loads
- > Home appliances
- > Communications (telephony)

and - at the same time - access the entertainment services that are offered by a broadband service provider, like:

- > Video on Demand
- > Interactive TV

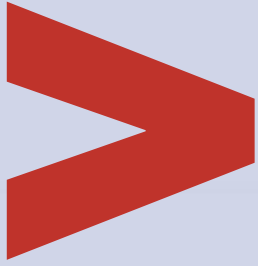

WAVES: The Home in your Hand

The Home Automation system is a modular solution that's made of the following basic components:

- > The **Domotic Bridge**, the device that is connected to the domotic subsystems and enables their configuration and control;
- > The **Access Gateway**, the device that enables the connection of the Domotic Bridge to the broadband network
- > The **IP Video Station**, that enables IP Video Streaming and IP Video Telephony
- > The **Domotic Terminal**, the device that enables the user to control all the functions of the Home Automation system.

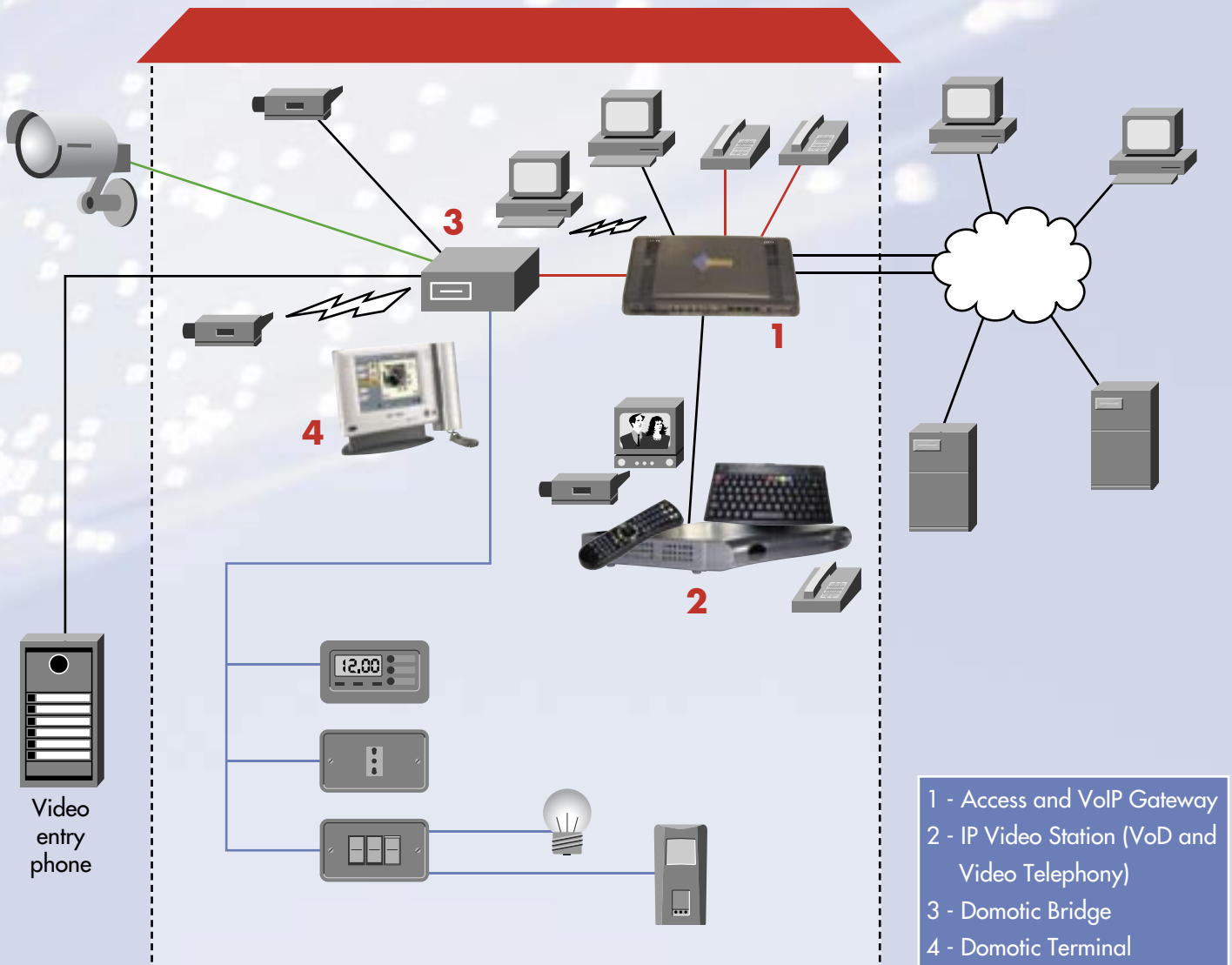

The Domotic Terminal is connected to the Bridge through a LAN, even wireless. The user can navigate the graphical interface and activate immediately the required functions:

- Setting up a scenario including the temperature, the lights switching on/off, the lock/unlock of the doors and all the other required functions is straightforward. After the setup the scenario can be activated with a click.
- Seeing a visitor ringing your bell in the Terminal, talk with him and open the door. If you're not at home, the system takes a picture of the visitor, stores it and - if requested - advises you by a Short Message or an E-Mail.
- Controlling your home through a set of cameras; your eyes can be everywhere in your home... while you're sitting in the living-room with the Terminal in your hand.
- Surfing the Internet using your Terminal.
- Seeing a movie, coming from the broadband network or you can look at the live TV, received by the Bridge and shown on the Terminal.
- And when you're out of home the system takes care of the security. If a door opens or the alarm is activated, the Home Automation system can send you a message or an E-Mail.



The Home Automation system from Telsey has been designed to fit into the most demanding home environments. The design of the Terminal - that's the entry point to the system - has been particularly refined. The same has been done for its smart wall and table supports that are to host the Terminal and to recharge it when it's not used.

All this is the home of the future and the Home Automation system of Telsey makes it a reality... NOW.