



Mounting Instructions

This appendix contains mounting instructions for the access point and contains the following topics:

- [Overview, page 3-2](#)
- [Mounting on a Horizontal or Vertical Surface, page 3-3](#)
- [Mounting on a Suspended Ceiling, page 3-4](#)
- [Using the Security Hasp Adapter, page 3-7](#)
- [Mounting on a Cubical Wall Partition, page 3-8](#)
- [Using the Desktop Holster, page 3-9](#)
- [Using the Cable Lock Feature, page 3-11](#)

Overview

The mounting brackets and hardware shipped with your access point enables you to mount it on any of the following surfaces:

- Horizontal or vertical flat surfaces, such as walls or ceilings
- Suspended ceilings
- Cubical partition walls
- Desktop or other suitable horizontal surface

The 1100 series access point provides adequate fire resistance and low smoke-producing characteristics suitable for operation in a building's environmental air space, such as above suspended ceilings, in accordance with Section 300-22(C) of the National Electrical Code (NEC) and Sections 2-128, 12-010(3) and 12-100 of the Canadian Electrical Code, Part 1, C22.1.



Caution

Only the fiber-optic power injector (AIR-PWRINJ-FIB) has been tested to UL 2043 for operation in a building's environmental air space; no other power injectors or power modules have been tested to UL 2043 and they should not be placed in a building's environmental air space, such as above suspended ceilings.

Security features for each of these mounting methods are also provided. You can use a Kensington lock (Notebook Microstar, model number 64068), which you must provide, to make the access point more secure when you mount it using any of the mounting options.

You can use the security hasp adapter provided by Cisco to secure the access point with a padlock when you use the wall or ceiling mounting bracket. The security hasp adapter provides maximum physical security for your access point.

A mounting hardware kit is provided that contains the hardware and fasteners necessary to mount the access point. Refer to [Table 3-1](#) to identify the materials you need to mount your access point, then go to the section containing the specific mounting procedure.

Table 3-1 Mounting Material

Mounting Method	Materials Required	In Kit
Horizontal or vertical surface	Wall or ceiling mounting bracket	Yes
	Security hasp adapter	Yes
	Four #8 x 1 in. (25.4 mm) screws	Yes
	Four wall anchors	Yes
	3/16 in. (4.7 mm) or 3/32 in. (2.3 mm) drill bit	No
	Drill	No
Suspended ceiling	Wall or ceiling mounting bracket	Yes
	Security hasp adapter	Yes
	Two caddy fasteners with studs	Yes
	Two plastic spacers	Yes
	Two 1/4–20 Keps nuts	Yes
	Standard screwdriver	No
	Appropriate wrench or pliers	No
Office cubical wall partition	Cubical partition mounting bracket assembly	Yes
Desktop	Desktop holster	Yes

The wall or ceiling mounting bracket also serves as a template for transferring the location of the bracket's mounting holes to the mounting surface. Refer to [Figure 3-1](#) to locate the various mounting holes for the method you intend to use.

Figure 3-1 Mounting Bracket

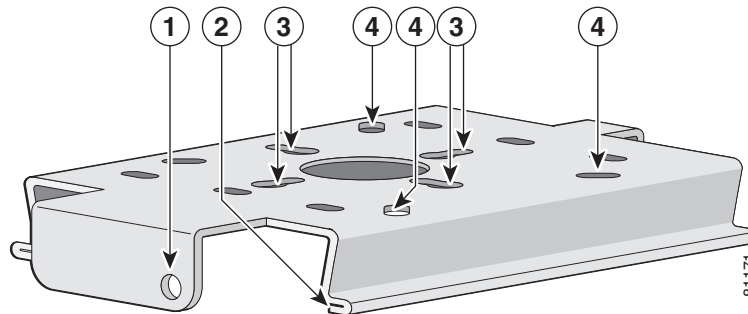

1	Security hasp	3	Suspended ceiling mount holes
2	Access point mounting rail	4	Wall mount holes

Mounting on a Horizontal or Vertical Surface

Follow these steps to mount the access point on a horizontal or vertical surface, such as a ceiling or wall.

-
- Step 1** Use the wall or ceiling mounting bracket as a template to mark the locations of the mounting holes.
- You can use any of the 10 holes around the periphery (three of which are identified in the illustration) of the bracket to mount it using the supplied #8 fasteners.
- Step 2** Drill one of the following sized holes at the locations you marked:
- 3/16 in. (4.7 mm) if you are using wall anchors
 - 3/32 in. (2.3 mm) if you are not using wall anchors
- Step 3** Install the anchors into the wall if you are using them. Otherwise, go to Step 4.
- Step 4** Secure the mounting bracket to the surface using the #8 fasteners.



Note On a vertical surface, be sure to mount the bracket with its security hasp facing down.

- Step 5** Line up the mounting slots on the access point with the mounting rail on the mounting bracket and slide down the mounting rails until it clicks into place.
-

Mounting on a Suspended Ceiling

Follow these steps to mount your access point on a suspended ceiling. It may be helpful to refer to [Figure 3-2](#) before beginning the process.

Figure 3-2 Suspended Ceiling Mounting Bracket Parts

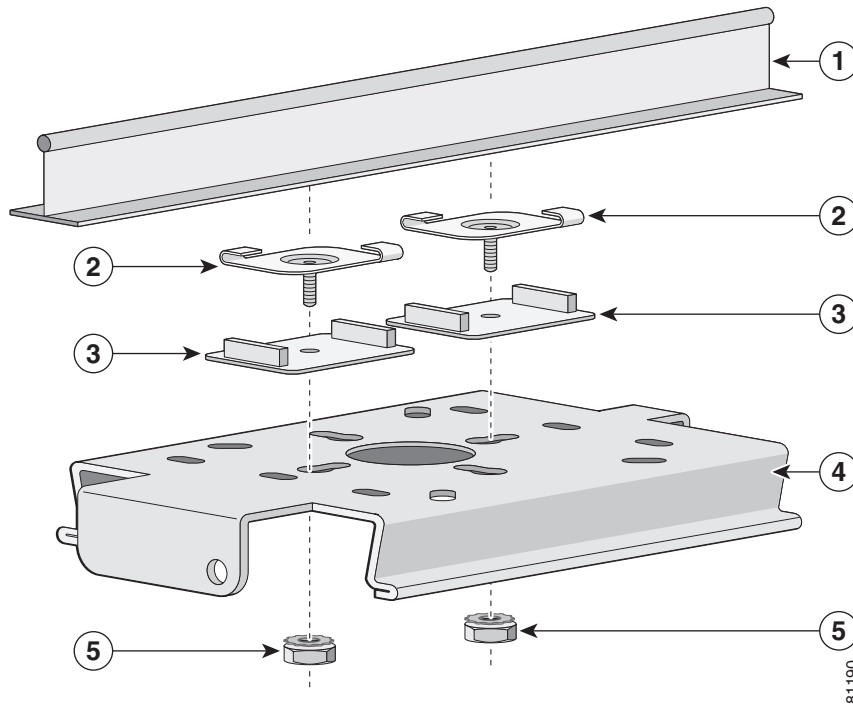

1	Suspended ceiling T-rail	4	Wall or ceiling mounting bracket
2	Caddy fastener	5	Keps nut
3	Plastic spacer		

-
- Step 1** Determine the location at which to mount the access point.
- Step 2** Attach two caddy fasteners to the ceiling's T-rail.
- Step 3** Use the wall or ceiling mounting bracket to adjust the distance between the caddy fasteners so that they align with the holes in the bracket.
- The distance between the caddy fastener studs is 2.5 in (6.35 cm).
- Step 4** Use a standard screwdriver to tighten the caddy fastener studs in place on the T-rail. Do not overtighten.
- Step 5** Install a plastic spacer on each caddy fastener stud. The spacer's legs should contact the ceiling grid T-rail.
- Step 6** Attach the wall or ceiling mounting bracket to the caddy fastener studs and start a Keps nut on each stud.
- Step 7** Use a wrench or pliers to tighten the Keps nuts. Do not overtighten.

- Step 8** Line up the mounting slots on the access point with the mounting rail on the wall or ceiling mounting bracket and slide it down the mounting rails until it clicks into place. See [Figure 3-3](#).

Figure 3-3 Access Point Mounting Slots

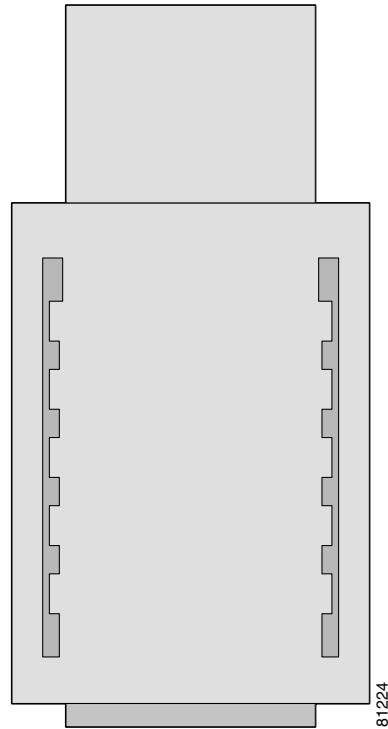

Mounting Above a Suspended Ceiling

The access point mounting bracket is designed to be integrated into the T-bar grid above the tiles of a suspended ceiling. The access point uses a T-bar box hanger (not supplied) such as the Erico Caddy 512 or B-Line BA12 and should be oriented just above the top surface of a standard 5/8-in. (1.59 cm) ceiling tile. You may need to modify a thicker tile to allow room for the access point.

Follow these steps to mount the access point above a suspended ceiling. Refer [Figure 3-4](#) before proceeding.

Figure 3-4 T-Bar Grid Mounting Bracket Parts

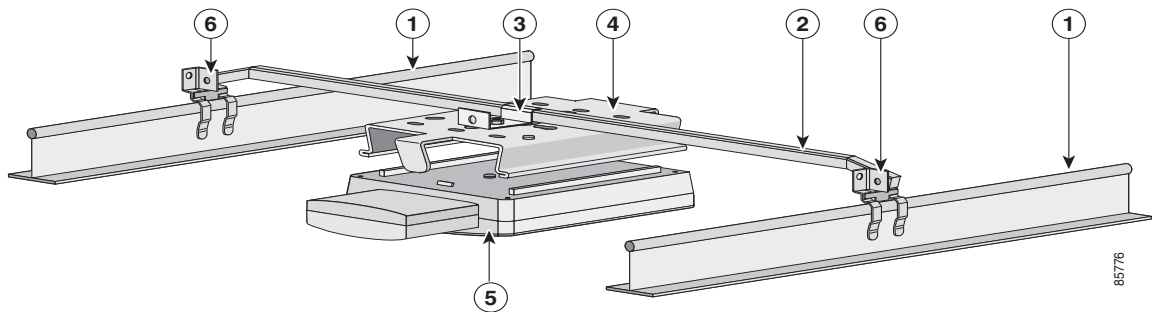

1	Suspended ceiling T-rail	4	Access point mounting bracket
2	T-bar box hanger	5	Access point
3	Bracket mounting clip	6	T-rail clip

- Step 1** Insert the bracket mounting clip's tab into the large hole on the access point mounting bracket.
- Step 2** Place the clip over the T-bar box hanger (refer to [Figure 3-5](#)) and secure it to the access point mounting bracket with the 1/4-20 fastener (supplied with the T-bar hanger).

Figure 3-5 T-Bar and Mounting Bracket

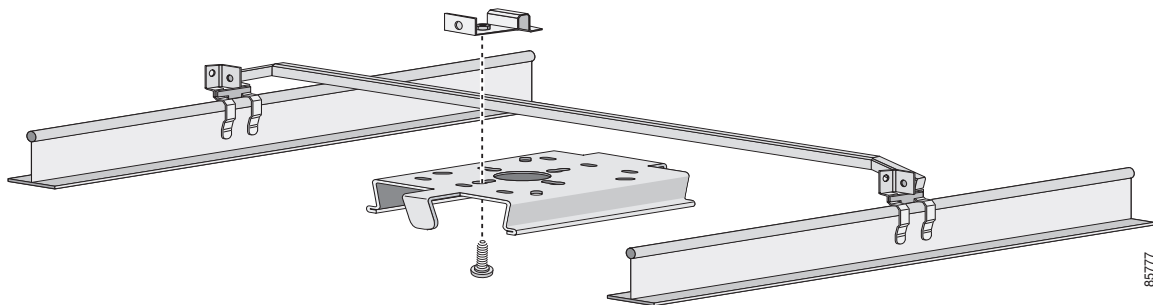

Note [Figure 3-5](#) shows the access point mounting bracket mounted perpendicular to the T-bar box hanger. You can also mount the bracket parallel to the T-bar box hanger.

- Step 3** Remove a ceiling tile adjacent to the mounting location.

- Step 4** Configure the ends of the T-bar box hanger to allow for maximum clearance above the ceiling tile. See the illustration above.
- Step 5** Attach the T-rail clips on the each end of the T-bar box hanger to the ceiling grid T-rails. Make sure the clips are securely attached to the T-rails.
- Step 6** Connect a drop wire to a building structural element and the hole provided in the bracket mounting clip. This additional support is required in order to comply with the U.S. National Electrical Safety Code.
- Step 7** Attach the access point to the access point mounting bracket.
- Step 8** Connect the Ethernet cables to the access point.



Note The power module and power injector are not rated for mounting above suspended ceilings. Therefore, you must use the Ethernet cable to supply power.

- Step 9** If you need additional security, you can secure the access point to a nearby immovable object using a Kensington lock and security cable.
- Step 10** Verify that the access point is operating before replacing the ceiling tile.

Using the Security Hasp Adapter

The security hasp on the wall or ceiling mounting bracket and the security hasp adapter locks the access point to the bracket to make it more secure. After you have installed the access point on the detachable mounting bracket, follow these steps to secure it with a padlock (Master Lock model 120T, 121T or equivalent).

- Step 1** Connect the Ethernet cable and power jack.
- Step 2** Insert the T-shaped tab on the security hasp adapter into the Kensington lock slot on the access point. See [Figure 3-6](#).

Figure 3-6 Security Hasp Adapter

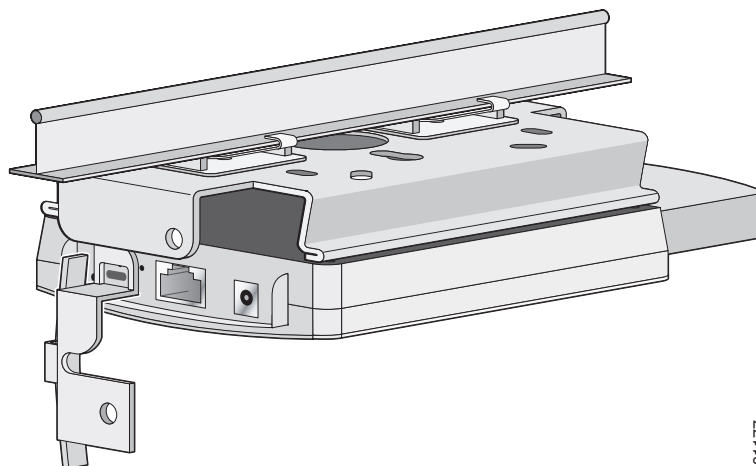

- Step 3** Rotate the adapter to engage it with the security hasp. The hole in the adapter should be aligned with the hole in the security hasp.
- Step 4** Secure the adapter to the security hasp with a padlock. Your installation will look similar to [Figure 3-7](#).

Figure 3-7 Security Hasp with Padlock

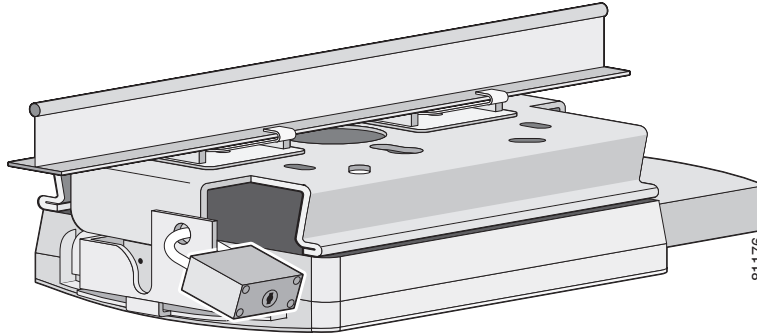

Mounting on a Cubical Wall Partition

Follow these steps to mount the access point on a cubical wall partition.

- Step 1** Select the place on the partition where you want to mount the access point.
- Step 2** Determine the width of the partition you are going to mount the access point on.
- Step 3** Assemble the cubical partition mounting bracket by sliding the two pieces together. You can use either the short or long part of the bracket to obtain the proper fit to the partition wall.
- The bracket is adjustable from 2.125 in. (5.39 cm) to 4.25 in. (10.79 cm).
- Step 4** Connect the Ethernet and power cables.
- Step 5** Line up the mounting slots on the access point with the mounting rails on the cubical partition mounting bracket and slide it down the rails until it clicks into place.

- Step 6** Position the mounting bracket over the partition wall and adjust it to fit. See [Figure 3-8](#).

Figure 3-8 Cubicle Wall Bracket

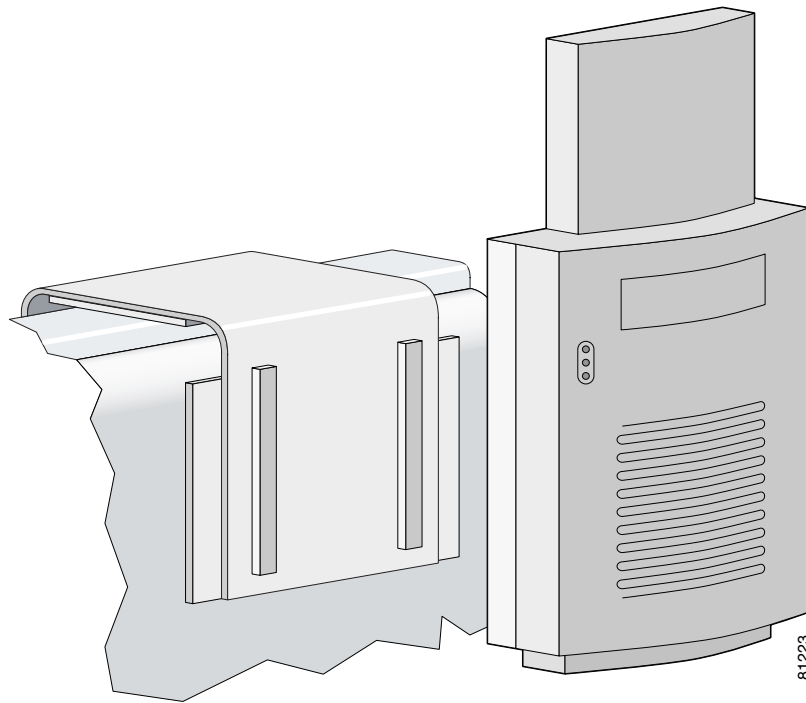

Using the Desktop Holster

Follow these steps to mount the access point on a desktop or other horizontal surface using the supplied desktop holster.

-
- Step 1** Select a suitable location to place the holster.
- Step 2** Connect the Ethernet and power cables.
- If you are going to secure the access point with a Kensington lock, attach it now.
- Step 3** Position the holster so that its back side is facing you.

- Step 4** Insert the access point into the holster while guiding the cables so that they do not interfere with the sides of the holster. You will hear a click when the access point locks into place. See [Figure 3-9](#).

Figure 3-9 Desktop Holster

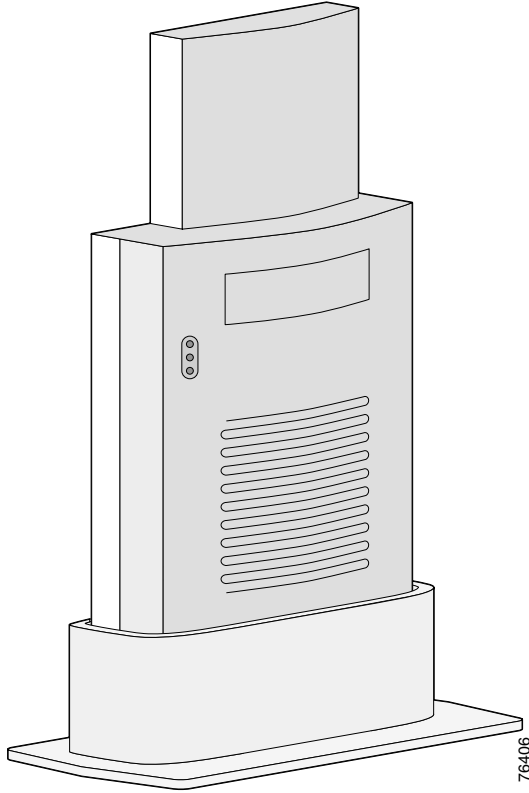

Using the Cable Lock Feature

When you mount the access point using the cubical partition mount or desktop holster, you can secure the access point with your own security cable. Follow these steps to install the security cable.

**Note**

Cisco recommends using a Kensington Notebook Microstar (model number 64068) to secure your access point.

- Step 1** Loop the security cable around a nearby immovable object.
- Step 2** Insert the key into the lock.
- Step 3** Insert the lock into the security slot on the access point.
- Step 4** Rotate the key right or left to secure the lock to the access point.
- Step 5** Remove the key.

A properly secured lock and cable look similar to [Figure 3-10](#).

Figure 3-10 Kensington Lock

