



ATEN KVM Switch Interoperability for Cisco UCS B and C Series Servers

First Published: March 28, 2016

Last Modified: March 29, 2016

Americas Headquarters

Cisco Systems, Inc.
170 West Tasman Drive
San Jose, CA 95134-1706
USA
<http://www.cisco.com>
Tel: 408 526-4000
800 553-NETS (6387)
Fax: 408 527-0883



CONTENTS

CHAPTER 1

ATEN KVM Switch Interoperability for UCS B and C Series Servers 1

Overview 1

CHAPTER 2

Component Matrix 3

Components Matrix 3

CHAPTER 3

KVM Interoperability Matrix 5

Test Matrix 5

Limitations 10

Issue Matrix 20

Related Documentation 21



ATEN KVM Switch Interoperability for UCS B and C Series Servers

- [Overview, page 1](#)

Overview

This document provides interoperability matrices for Cisco Unified Computing System Servers and Configurations that have been tested and validated by Cisco, Cisco partners, or both. Use this document as a reference for supported hardware and software.

The KVM interoperability test mainly validates the KVM accessibility of servers from ATEN-1716A KVM Switch with different flavors of Operating System such as Windows, RHEL, CentOS, SUSE and VMWare ESXi Hypervisor. Also validating the product's functionality on the Japanese OS and control through KVM switch on servers. The ATEN KVM Switch is tested with Cisco UCS B series and C series servers for Hotkeys, OSD key functionalities in Japanese environment.

Audience

This document is designed for use by Cisco sales, support engineers, professional service partners and system administrators responsible for the design and deployment of the Unified Computing System in the data center environment.

This document applies to the Cisco B460 M4, B260 M4, B200 M4, C3160, C3260, C220 M4, C240 and C460 M4, servers in Cisco Unified Computing System release 3.1(1e) and CIMC 2.0(9e), 2.0(9d).

Acronyms

Acronym	Description
KVM	Keyboard Video and Mouse
LAN	Local Area Network
MLOM	Modular LAN on Mother Board
OS	Operating System
OSD	On-Screen Display

Acronym	Description
RHEL	Red Hat Enterprise Linux
SIOC	System Input Output Controller
SLES	SUSE Linux Enterprise Server
UCS	Unified Computing System
UCSM	Unified Computing System Manager
VIC	Virtual Interface Card



CHAPTER 2

Component Matrix

- [Components Matrix, page 3](#)

Components Matrix

Component Version	Model
Server	
Cisco UCS 5108 Chassis	3.1(1e)
Fabric Interconnect 6296	5.2(3)N2(2.52a)
UCS Manager	3.1(1e)
CIMC	2.0(9d), 2.0(9e)
UCS Driver Bundle	ucs-bxxx-drivers.3.1.1, ucs-cxxx-drivers.2.0.9
Adapter	
VIC 1380	3.1(1e)
VIC 1225	2.0(9e)
VIC 1227	2.0(9d)
VIC 1300	2.0(9d)



CHAPTER 3

KVM Interoperability Matrix

- [Test Matrix, page 5](#)
- [Limitations, page 10](#)
- [Issue Matrix, page 20](#)
- [Related Documentation, page 21](#)

Test Matrix

- [Cisco UCS B200M4, on page 5](#)
- [Cisco UCS B260 M4, on page 6](#)
- [Cisco UCS B460M4, on page 6](#)
- [CISCO UCS C220M4, on page 7](#)
- [CISCO UCS C240M4, on page 7](#)
- [CISCO UCS C460M4, on page 8](#)
- [Cisco UCS C3160, on page 8](#)
- [Cisco UCS C3260, on page 9](#)

Cisco UCS B200M4

S.No	Cisco UCS Blade Server	Operating System	Storage	Adapter	Observation
1	Cisco UCS B200M4	Windows Server 2012	Local storage	VIC 1380	Passed
2	Cisco UCS B200M4	Windows Server 2012 R2	Local storage	VIC 1380	Passed
3	Cisco UCS B200M4	SUSE 12	Local storage	VIC 1380	Passed

S.No	Cisco UCS Blade Server	Operating System	Storage	Adapter	Observation
4	Cisco UCS B200M4	RHEL 7.1	Local storage	VIC 1380	Passed
5	Cisco UCS B200M4	RHEL 7.2	Local storage	VIC 1380	Passed
6	Cisco UCS B200M4	CentOS 7.0	Local storage	VIC 1380	Passed
7	Cisco UCS B200M4	CentOS 7.1	Local storage	VIC 1380	Passed
8	Cisco UCS B200M4	ESXi 6.0	Local storage	VIC 1380	Passed
9	Cisco UCS B200M4	ESXi 6.0 U1	Local storage	VIC 1380	Passed

Cisco UCS B260 M4

S.No	UCS Blade Server	Operating System	Storage	Adapter	Observation
1	Cisco UCS B260 M4	Windows Server 2012	Local Storage	1380	Limitation 1, on page 10
2	Cisco UCS B260 M4	Windows Server 2012 R2	Local Storage	1380	Limitation 2, on page 10
3	Cisco UCS B260 M4	SUSE 12	Local Storage	1380	Passed
4	Cisco UCS B260 M4	RHEL 7.1	Local Storage	1380	Passed
5	Cisco UCS B260 M4	RHEL 7.2	Local Storage	1380	Passed
6	Cisco UCS B260 M4	Cent OS 7.0	Local Storage	1380	Passed
7	Cisco UCS B260 M4	Cent OS 7.1	Local Storage	1380	Passed
8	Cisco UCS B260 M4	ESXi 6.0	Local Storage	1380	Passed
9	Cisco UCS B260 M4	ESXi 6.0 U1	Local Storage	1380	Passed

Cisco UCS B460M4

SNo	Cisco UCS Blade Server	Operating System	Storage	Adapter	Observation
1	Cisco UCS B460M4	Windows Server 2012	Local storage	VIC 1380	Limitation 3, on page 11
2	Cisco UCS B460M4	Windows Server 2012 R2	Local storage	VIC 1380	Limitation 4, on page 12

SNo	Cisco UCS Blade Server	Operating System	Storage	Adapter	Observation
3	Cisco UCS B460M4	SUSE 12	Local storage	VIC 1380	Passed
4	Cisco UCS B460M4	RHEL 7.1	Local storage	VIC 1380	Passed
5	Cisco UCS B460M4	RHEL 7.2	Local storage	VIC 1380	Passed
6	Cisco UCS B460M4	CentOS 7.0	Local storage	VIC 1380	Passed
7	Cisco UCS B460M4	CentOS 7.1	Local storage	VIC 1380	Passed
8	Cisco UCS B460M4	ESXi 6.0	Local storage	VIC 1380	Passed
9	Cisco UCS B460M4	ESXi 6.0 U1	Local storage	VIC 1380	Passed

CISCO UCS C220M4

S.No	Rack Server	Operating System	Storage	Adapter	Observation
1	Cisco UCS C220M4	Windows Server 2012	Local storage	VIC 1227	Passed
2	Cisco UCS C220M4	Windows Server 2012 R2	Local storage	VIC 1227	Passed
3	Cisco UCS C220M4	SUSE 12	Local Storage	VIC 1227	Passed
4	Cisco UCS C220M4	RHEL 7.2	Local Storage	VIC 1227	Passed
5	Cisco UCS C220M4	ESXi 6.0	Local Storage	VIC 1227	Passed
6	Cisco UCS C220M4	ESXi 6.0 U1	Local Storage	VIC 1227	Passed

CISCO UCS C240M4

S.No	Rack Server	Operating System	Storage	Adapter	Observation
1	Cisco UCS C240M4	Windows Server 2012	Local storage	VIC 1225	Passed
2	Cisco UCS C240M4	Windows Server 2012 R2	Local storage	VIC 1225	Passed
3	Cisco UCS C240M4	SUSE 12	Local Storage	VIC 1225	Passed
4	Cisco UCS C240M4	RHEL 7.2	Local Storage	VIC 1225	Passed

S.No	Rack Server	Operating System	Storage	Adapter	Observation
5	Cisco UCS C240M4	ESXi 6.0	Local Storage	VIC 1225	Passed
6	Cisco UCS C240M4	ESXi 6.0 U1	Local Storage	VIC 1225	Passed

CISCO UCS C460M4

S.No	Rack Server	Operating System	Storage	Adapter	Observation
1	Cisco UCS C460M4	Windows Server 2012	Local storage	VIC 1225	Passed
2	Cisco UCS C460M4	Windows Server 2012 R2	Local Storage	VIC 1225	Passed
3	Cisco UCS C460M4	SUSE 12	Local Storage	VIC 1225	Passed
4	Cisco UCS C460M4	RHEL 7.1	Local Storage	VIC 1225	Passed
5	Cisco UCS C460M4	RHEL 7.2	Local Storage	VIC 1225	Passed
6	Cisco UCS C460M4	CentOS 7.0	Local Storage	VIC 1225	Limitation 5, on page 13
7	Cisco UCS C460M4	CentOS 7.1	Local Storage	VIC 1225	Limitation 8, on page 14
8	Cisco UCS C460M4	ESXi 6.0	Local Storage	VIC 1225	Passed
9	Cisco UCS C460M4	ESXi 6.0 U1	Local storage	VIC 1225	Passed

Cisco UCS C3160

S.No	Rack Server	Operating system	Storage	Adapter	Observation
1	Cisco UCS C3160	Windows Server 2012	Local storage	VIC 1227	Passed
2	Cisco UCS C3160	Windows Server 2012 R2	Local storage	VIC 1227	Passed
3	Cisco UCS C3160	SUSE 12	Local storage	VIC 1227	Passed
4	Cisco UCS C3160	RHEL 7.1	Local storage	VIC 1227	Limitation 12, on page 18

S.No	Rack Server	Operating system	Storage	Adapter	Observation
5	Cisco UCS C3160	RHEL 7.2	Local storage	VIC 1227	Passed
6	Cisco UCS C3160	CentOS 7.0	Local storage	VIC 1227	Limitation 6, on page 14
7	Cisco UCS C3160	CentOS 7.1	Local storage	VIC 1227	Limitation 9, on page 15
8	Cisco UCS C3160	ESXi 6.0	Local storage	VIC 1227	Passed
9	Cisco UCS C3160	ESXi 6.0 U1	Local storage	VIC 1227	Passed

Cisco UCS C3260

S.No	Rack Server	Operating System	Storage	Adapter	Observation
1	Cisco UCS C3260	Windows Server 2012	Local storage	VIC 1300 SIOC	Passed
2	Cisco UCS C3260	Windows Server 2012 R2	Local storage	VIC 1300 SIOC	Passed
3	Cisco UCS C3260	SUSE 12	Local storage	VIC 1300 SIOC	Passed
4	Cisco UCS C3260	RHEL 7.1	Local storage	VIC 1300 SIOC	Passed
5	Cisco UCS C3260	RHEL 7.2	Local storage	VIC 1300 SIOC	Passed
6	Cisco UCS C3260	CentOS 7.0	Local storage	VIC 1300 SIOC	Limitation 7, on page 14
7	Cisco UCS C3260	CentOS 7.1	Local storage	VIC 1300 SIOC	Limitation 10, on page 16
8	Cisco UCS C3260	ESXi 6.0	Local storage	VIC 1300 SIOC	Passed
9	Cisco UCS C3260	ESXi 6.0 U1	Local storage	VIC 1300 SIOC	Passed

Limitations

Limitation 1

Windows server 2012 installation failed on B260 M4 via ATEN KVM Switch/Direct KVM

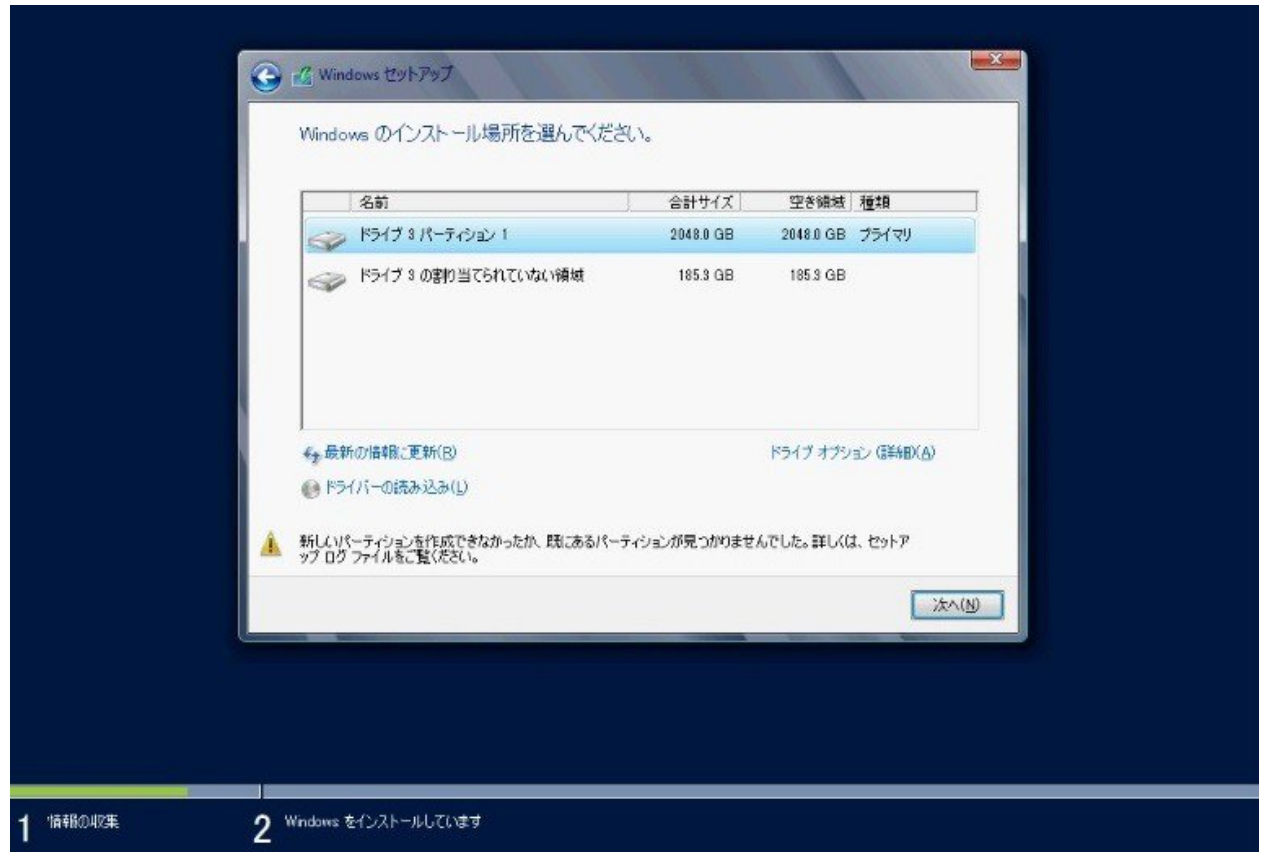

Limitation 2

Windows server 2012 R2 installation failed on B260 M4 via ATEN KVM Switch/Direct KVM

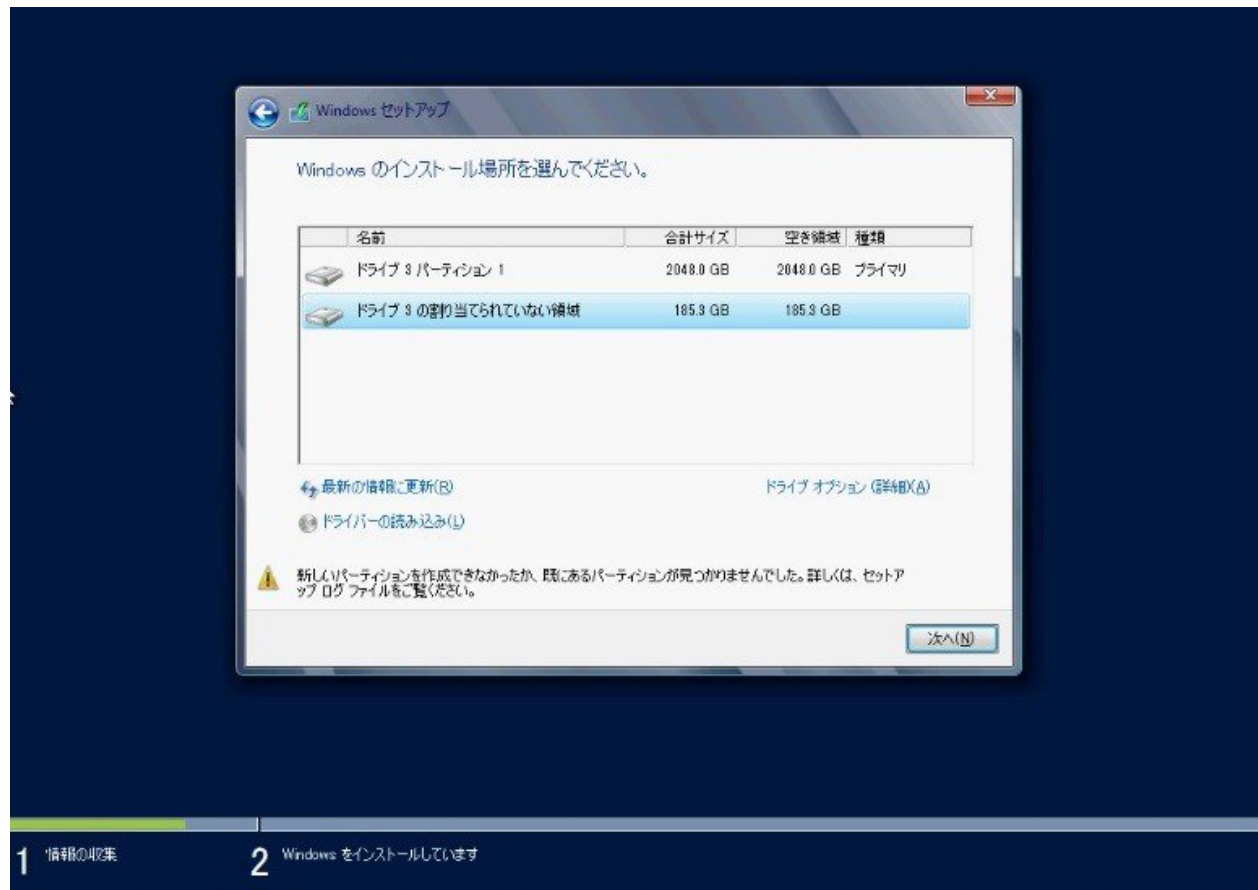

Limitation 3

Windows server 2012 installation failed on B460 M4 via ATEN KVM Switch/Direct KVM

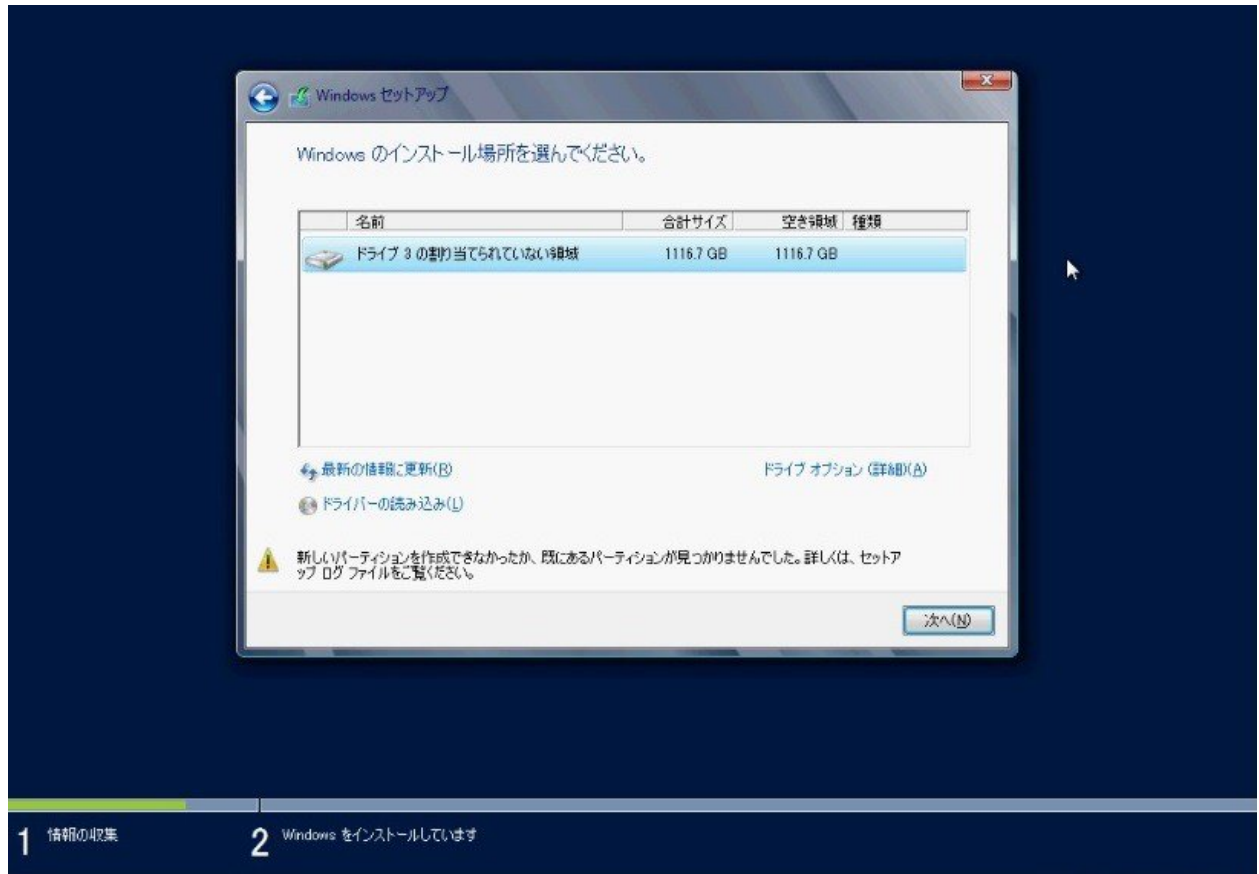

Limitation 4

Windows server 2012 R2 installation failed on B460 M4 via ATEN KVM Switch/Direct KVM

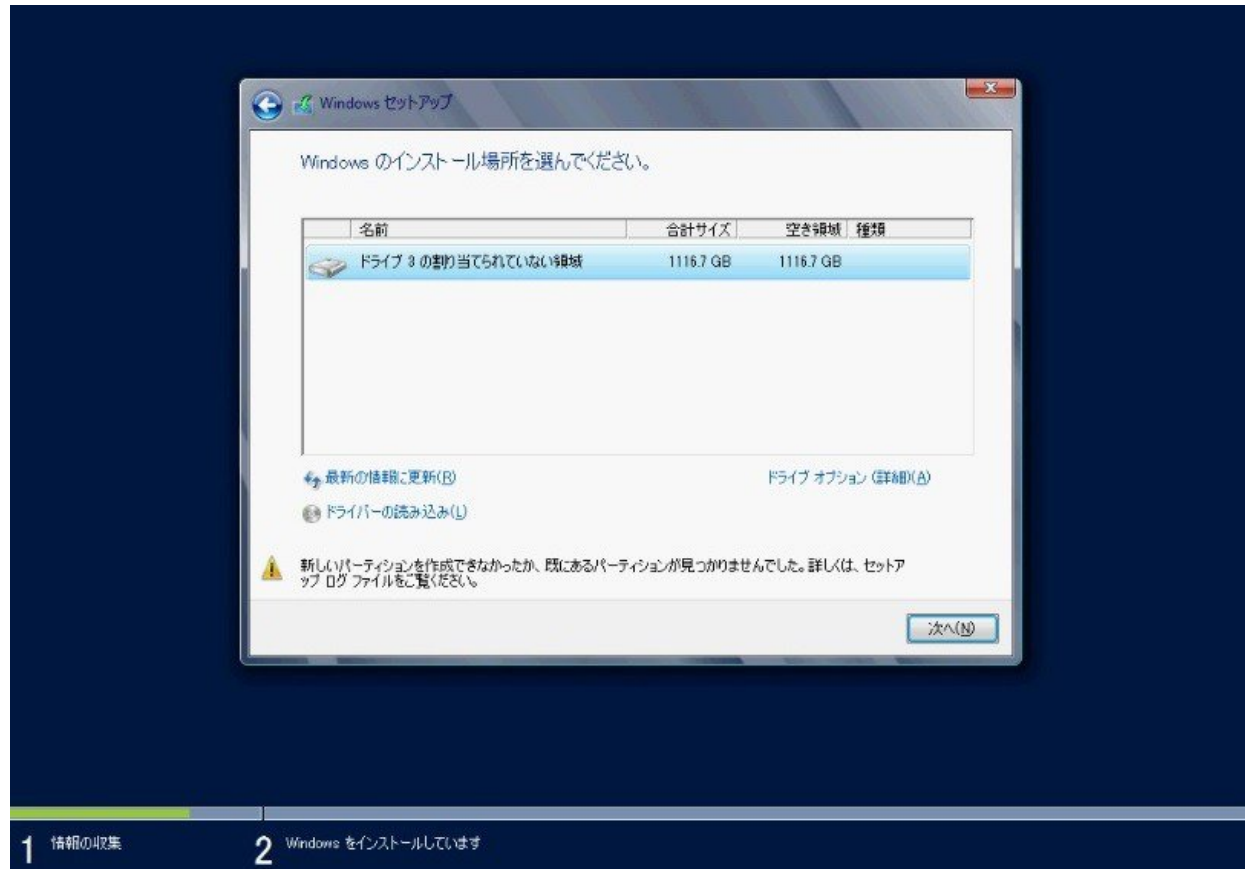

1 情報の収集

2 Windows をインストールしては

Limitation 5

CentOS 7.0 failed to install on C460 M4 via ATEN KVM Switch/Direct KVM

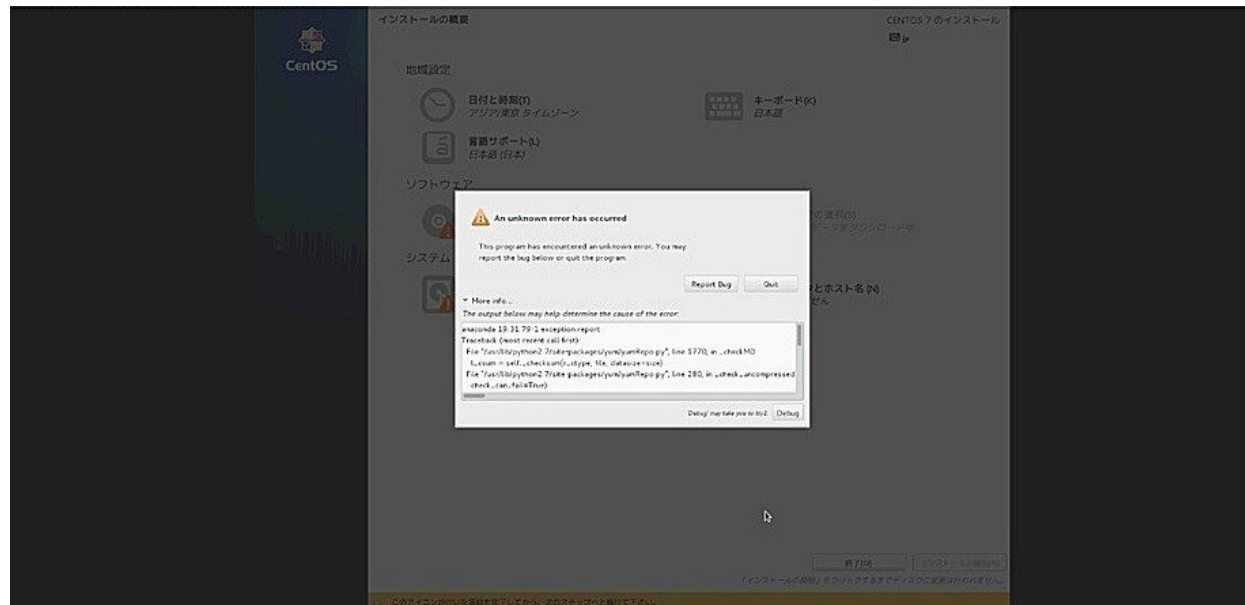

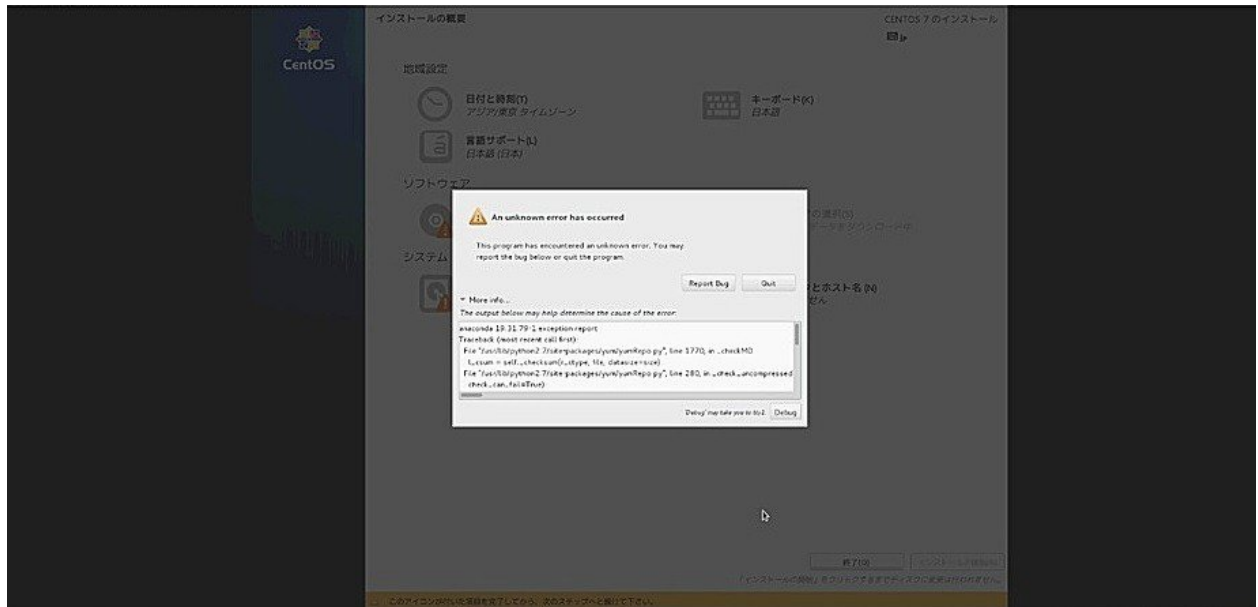
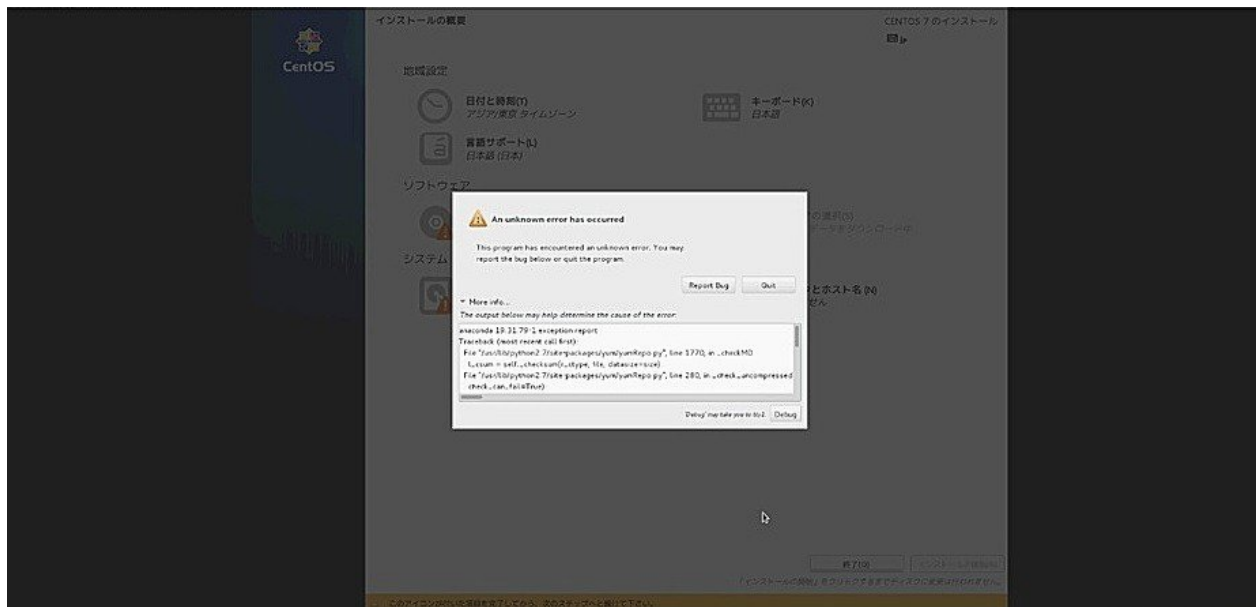
Limitation 6**CentOS 7.0 failed to install on C3160 via ATEN KVM Switch****Limitation 7****CentOS 7.0 failed to install on C3260 via ATEN KVM Switch****Limitation 8****CentOS 7.1 failed to install on C460 M4 via ATEN KVM Switch/Direct KVM**

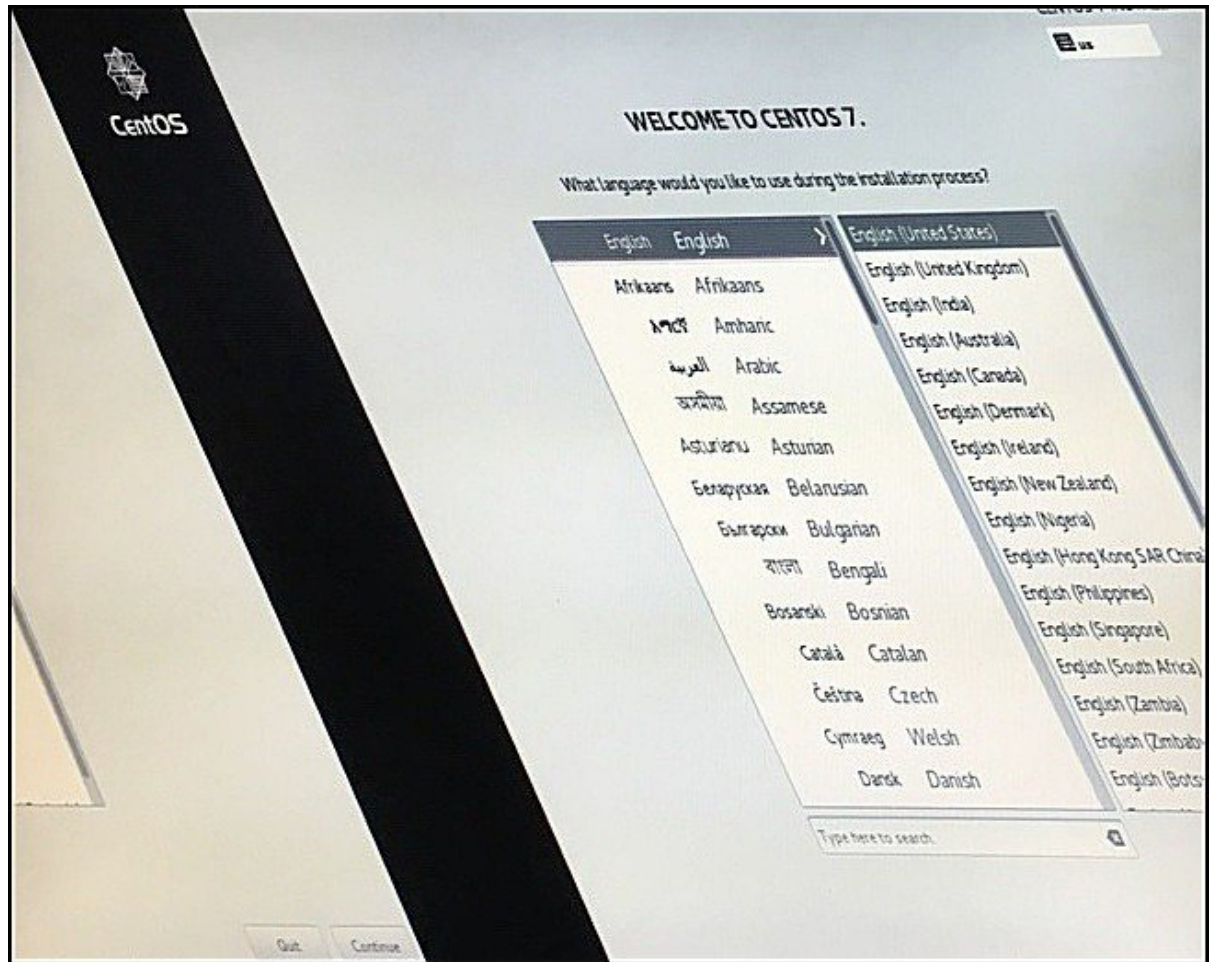

Limitation 9

CentOS 7.1 failed to install on C3160 via ATEN KVM Switch

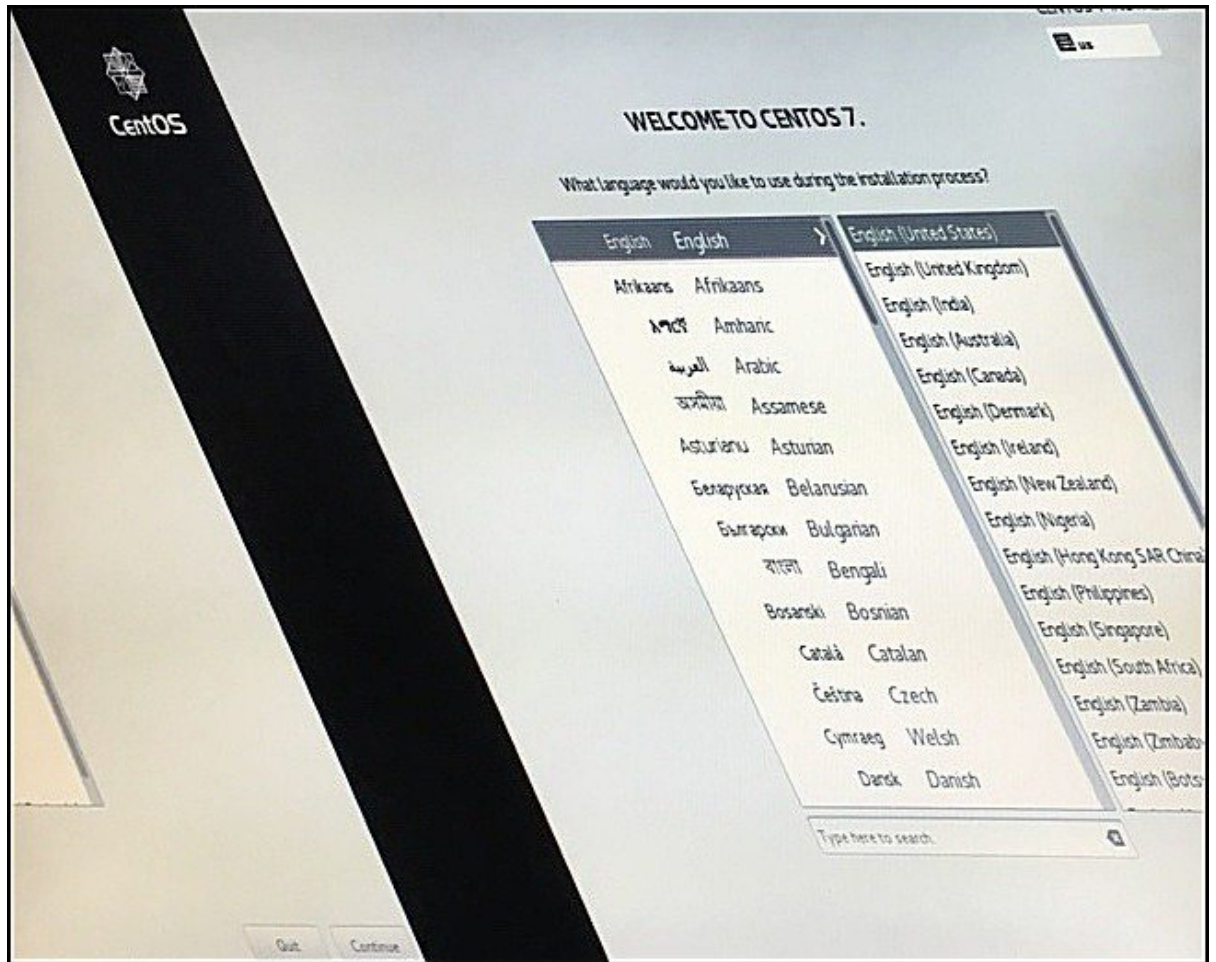

Limitation 10

CentOS 7.1 failed to install on C3260 via ATEN KVM Switch

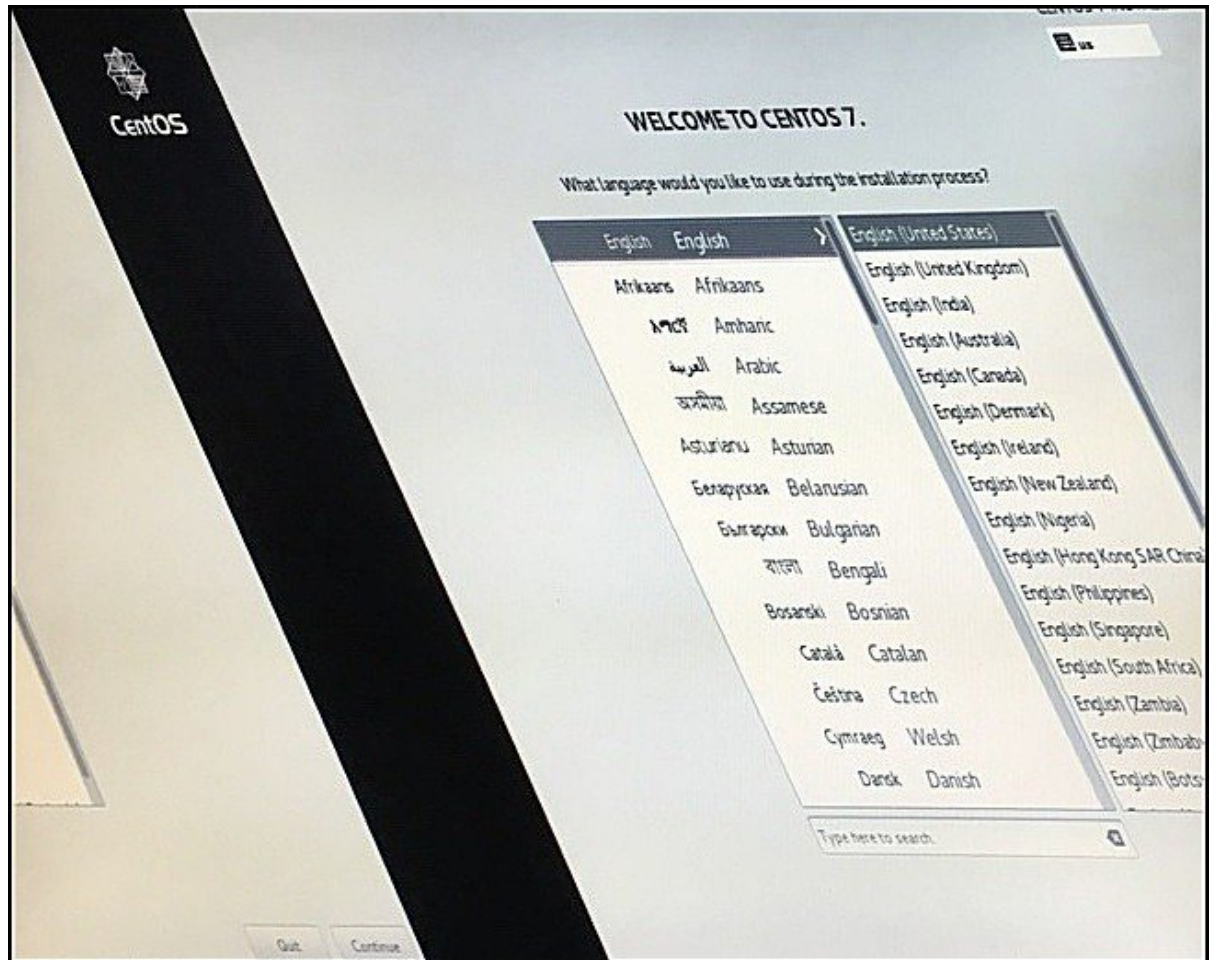

Limitation 11

Quick View port issue

Description:

This function lets the administrator to select which ports to include as quick view ports (frequently used ports). ATEN KVM Switch failed to configure this OSD function.

```
F1:GOTO F3:SET F5:SKP F7:SCAN
F2:LIST F4:ADM F6:BRC F8:LOUT
ADMINISTRATOR
LIST:ALL
SN--PN QV ◊ NAME
01
02
03
04
05
06
07
INVALID KEY.
```

Limitation 12

RHEL 7.1 failed to install on C3160 via ATEN KVM Switch/Direct KVM

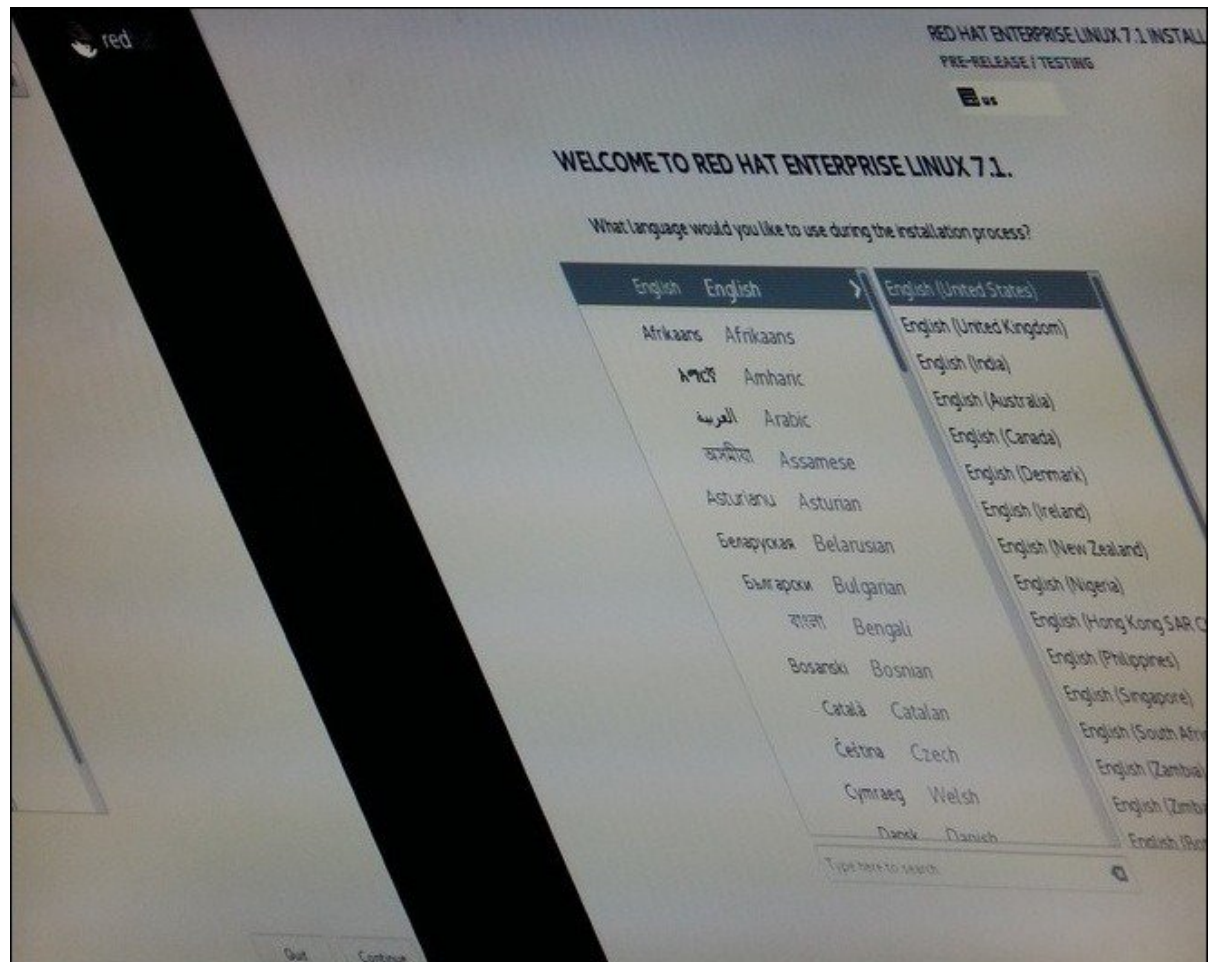

RHEL 7.1 failed to install on C3160 and throws an error message

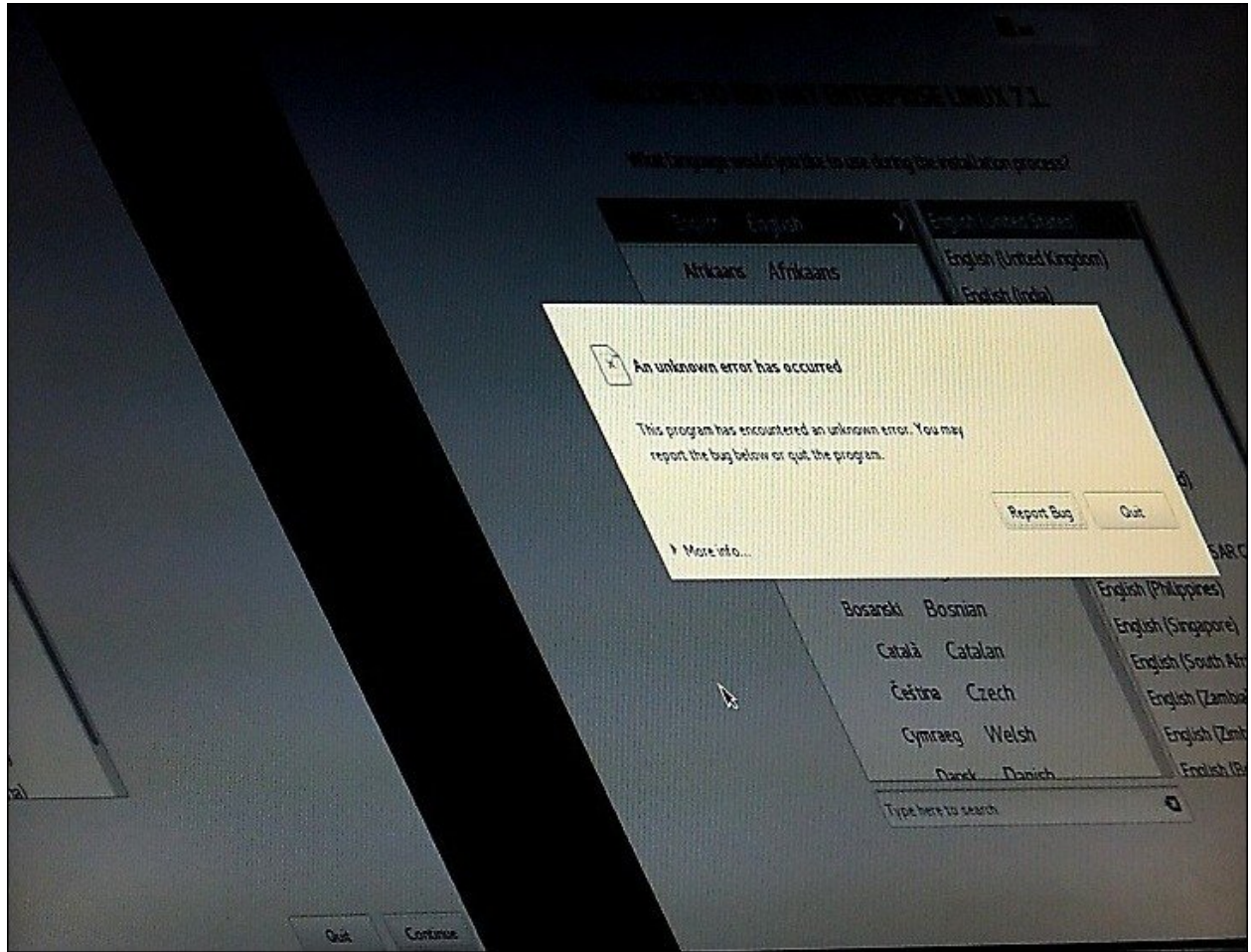

Issue Matrix

Limitations	OS	ATEN KVM Switch	Server Direct KVM	server
Limitation 1	Windows server 2012	Issue	Issue	B260 M4
Limitation 2	Windows server 2012 R2	Issue	Issue	B260 M4
Limitation 3	Windows server 2012	Issue	Issue	B460 M4
Limitation 4	Windows server 2012 R2	Issue	Issue	B460 M4
Limitation 5	Cent OS 7.0	Issue	Issue	C460 M4
Limitation 6	Cent OS 7.0	Issue	Direct KVM Passed	C3160
Limitation 7	Cent OS 7.0	Issue	Direct KVM Passed	C3260

Limitations	OS	ATEN KVM Switch	Server Direct KVM	server
Limitation 8	Cent OS 7.1	Issue	Issue	C460 M4
Limitation 9	Cent OS 7.1	Issue	Direct KVM Passed	C3160
Limitation 10	Cent OS 7.1	Issue	Direct KVM Passed	C3260
Limitation 12	RHEL 7.1	Issue	Issue	C3160

Related Documentation

Hardware and Software Interoperability Matrix

http://www.cisco.com/c/dam/en/us/td/docs/unified_computing/ucs/interoperability/matrix/b_hcl_C_rel-2-0-9.pdf

http://www.cisco.com/c/dam/en/us/td/docs/unified_computing/ucs/interoperability/matrix/b_hcl_B_rel3-11.pdf

Cisco Unified Computing System-Technical References

<http://www.cisco.com/c/en/us/support/servers-unified-computing/unified-computing-system/>

Software Download

<https://software.cisco.com/download/navigator.html?mdfid=283612685&flowid=76422>

ATEN KVM CS 1716A

http://www.aten.com/doc_data/pdf_dm/cs1708a_1716a Rack_KVM_Switch_DS_en.pdf

Switch manual document

http://www.aten.com/download/download_m.php?modelNo=CS1716A

ATEN KVM Specifications

http://www.aten.com/doc_data/pdf_dm/cs1708a_1716a Rack_KVM_Switch_DS_en.pdf

