

Cisco Digital Set-Top Recorder Model 8389DVB Digital Video Recorder

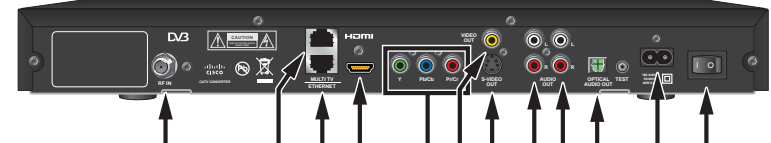

Back Panel



- 1 RF In
2 Multi TV
3 Ethernet
4 HDMI
5 Y Pb Pr
6 Video Out
7 S-Video Out
8 Audio Out (L/R)
9 Audio Out (L/R)
10 Optical Audio Out
11 AC In
12 On/Off Switch

DVR Functions Understanding the Live TV Buffer and Recordings

The Live TV Buffer allows you to control Live TV and DVR recording while you are watching live TV. This DVR buffer stores 60 minutes of content from the channel you are watching.

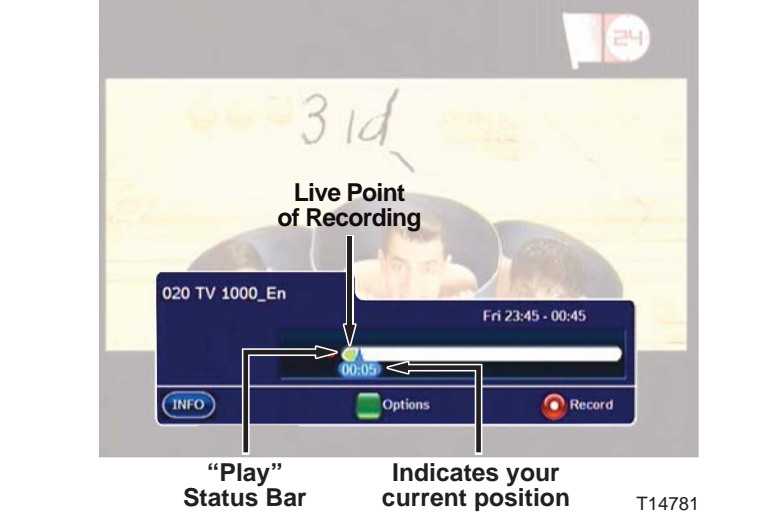

We will use two examples to show how the Live TV Buffer works. For both examples, we will assume that a football match on a sports channel starts at 3:00 PM and ends at 4:00 PM. Example 1: You tune to the sports channel at 2:45 PM (15 minutes before the football match starts). You decide to start recording the football match between 3:00 PM and 3:45 PM, so you press the RECORD button on your remote and then you select the option to record until the end of the program.

Favorites List

To view a different Favorites list in the EPG, press EPG, then press the Red key. When you press the Red key, the favorite name becomes highlighted and you can navigate left and right to change the Favorites list. The box at the top of the grid shows the current Favorites list. Use the left and right arrow keys to select a different Favorites list, and then press OK.

Setting Up Favorites Lists

To set up or change a Favorites list in the Main Menu, use the arrow keys to scroll down to Favorites and click OK. Any Favorites list that you create will be marked with a blue star. These are the only lists you can change. Press the Green key to create a list. Use the arrow keys to enter a name for the list. Use the up and down arrows to change characters, and use the right arrow key to add new characters. Press OK when you finish entering the name. The list of available channels appears on the right-hand side of the screen. Use the up and down arrows to select the channels you want to add, and press the Green key to add them to the list of favorite channels on the left.

Notice for Installers

The servicing instructions in this notice are for use by qualified service personnel only. To reduce the risk of electric shock, do not perform any servicing other than that contained in the operating instructions, unless you are qualified to do so.

CAUTION: To reduce the risk of electric shock, do not remove cover (or back). Do not use serviceable parts inside. Refer service to qualified service personnel. WARNING: TO PREVENT FIRE/ELECTRIC SHOCK, DO NOT EXPOSE THIS UNIT TO RAIN OR MOISTURE.

20080814_Installer200

Contents

IMPORTANT SAFETY INSTRUCTIONS.....2
Welcome.....4
Safety First.....4
Serial Number and MAC Address.....4
About the Remote Control.....5
Front Panel.....6
Back Panel.....7
Connecting the Set-Top.....8
Connecting to a TV.....9
Watch TV.....10
Setup Wizard.....10
Set Parental Control PIN.....11
Revert to Factory Settings.....11
Navigator Bar.....12
Color-Coded Options.....12
DVR Functions.....15
Understanding the Live TV Buffer and Recordings.....15
Instant Recording.....17
Recording Menu.....17
Manual Recording.....19
Recording Settings.....19
Electronic Program Guide.....20
Record from the Program Guide.....20
View Blocked Channels.....21
Set Blocking Options.....21
Program Information.....22
Options.....22
Favorites List.....23
Setting up Favorites Lists.....23
Program Reminders.....24
Displaying Picture-in-Picture (PIP).....25
On Demand.....26
Ordering VOD Services.....27
Troubleshooting.....28
No Picture.....28
No Color.....28
No Sound.....28

Connecting the Set-Top

To connect your set-top to your entertainment devices, complete these steps.

- 1 Connect your TV to the set-top. (See connection diagram.)
2 Plug the set-top and the TV into a power source that is not controlled by a wall switch.
3 Do not turn on the set-top or TV yet.
4 Wait for the power LED to illuminate. It may take several minutes for the set-top to receive the latest software, programming, and service information.
5 Press POWER on the remote control.
6 The first time you turn on the set-top, the Setup Wizard will start. Read and follow the directions on the screen to get your set-top ready for use.

Connecting to a TV

WARNING: Electric shock hazard! Unplug all electronic devices before connecting or disconnecting any device cables to the set-top.

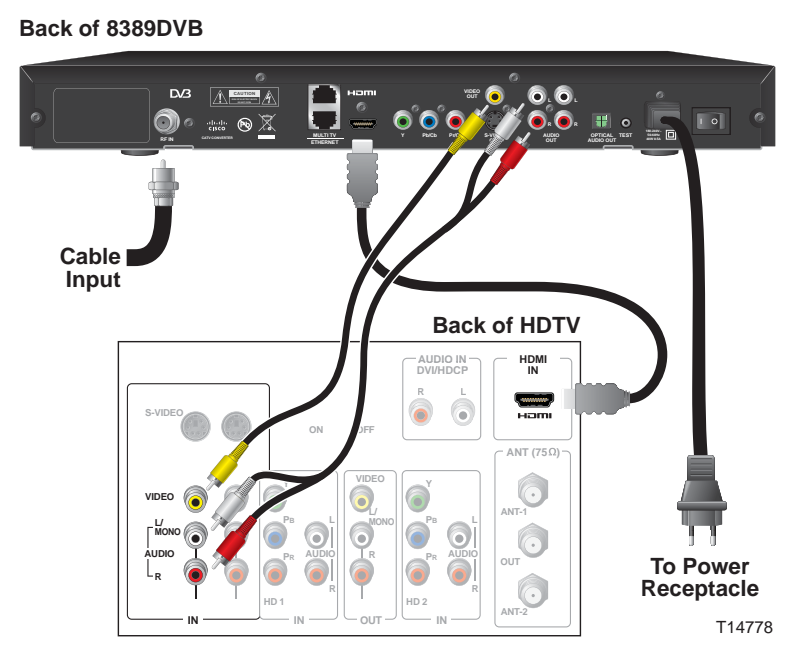

IMPORTANT SAFETY INSTRUCTIONS, continued

- 1 Read these instructions.
2 Keep these instructions.
3 Read all warnings.
4 Follow all instructions.
5 Do not use this apparatus near water.
6 Clean only with dry cloth.
7 Do not block any ventilation openings, install in accordance with the manufacturer's instructions.
8 Do not install near any heat sources such as radiators, heat registers, stoves, or other apparatus (including amplifiers) that produce heat.
9 Do not defeat the safety purpose of the polarized or grounding-type plug. A polarized plug has two blades with one wider than the other. A grounding-type plug has two blades and a third prong or ground pin provided for your safety. If the provided plug does not fit into your outlet, consult an electrician for replacement of the obsolete outlet.
10 Protect the power cord from being walked on or pinched particularly at plugs, convenience receptacles, and the point where they exit from the apparatus.
11 Only use attachments/accessories specified by the manufacturer.
12 Use only with the car, stand, tripod, bracket, or table specified by the manufacturer, or sold with the apparatus. When a cart is used, use caution when moving the cart/appliance combination to avoid injury from tip-over.
13 Unplug this apparatus during lightning storms or when unused for long periods of time.
14 Refer all servicing to qualified service personnel. Servicing is required when the apparatus has been damaged in any way such as a power supply cord or plug is damaged, liquid has been spilled or objects have fallen into the apparatus, the apparatus has been exposed to rain or moisture, does not operate normally, or has been dropped.
Power Source Warning
A label on this product indicates the correct power source for this product. Operate this product only from an electrical outlet with the voltage and frequency indicated on the product label. If you are uncertain of the type of power supply to your home or business, consult your service provider or your local power company. The AC cord on the unit must remain accessible and operate at all times.
Ground the Product
The AC cord on the unit must remain accessible and operate at all times.
WARNING: Avoid electric shock and fire hazard! If this product connects to coaxial cable wiring, be sure the cable system is grounded (earthed). Grounding provides some protection against voltage surges and built-up static charges.
WARNING: Avoid electric shock and fire hazard! Do not locate an outside antenna system in the vicinity of overhead power lines or power circuits. Touching power lines or circuits might be fatal.
Protect the Product from Lightning
In addition to disconnecting the AC power from the wall outlet, disconnect the signal inputs.
Verify the Power Source from the On/Off Power Light
When the on/off power light is illuminated, the apparatus may still be connected to the power source. The light may go on when the apparatus is turned off, regardless of whether it is plugged into an AC power source.
Eliminate AC Mains Overloads
WARNING: Avoid electric shock and fire hazard! Do not overload AC mains, outlets, extension cords, or integral convenience receptacles. For products that require battery power or other power sources to operate them, refer to the operating instructions for those products.

Watch TV

When you turn on the set-top, you will see a screen with the service provider logo until the set-top has downloaded the latest programming information.

Setup Wizard

The first time you turn on the set-top, you will see the Setup Wizard window. In the Setup Wizard you can select the language and screen settings for your video control. Read and follow the directions on each screen of the Setup Wizard. If you want to change any of the settings at a later time, you can access the Setup Wizard by choosing Revert to Factory Settings within the Settings option on the Main Menu. Doing so will erase all of your setup choices and display the Setup Wizard again.

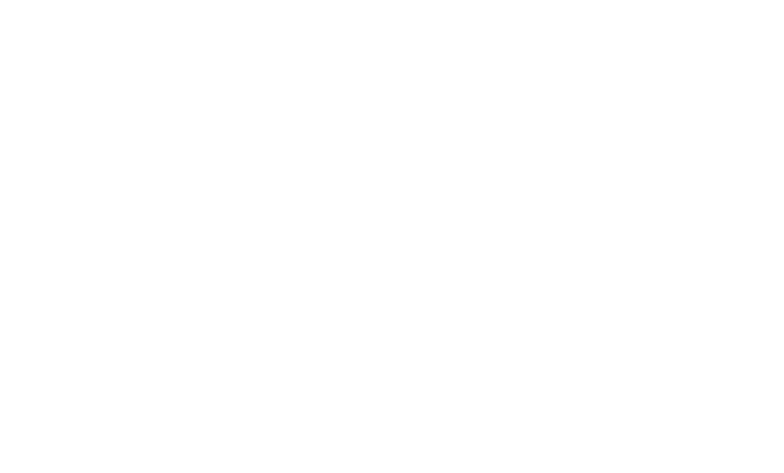

Parental Control

To set the Parental Control PIN, press the Menu key on the remote control, then scroll down to Settings and press the OK key. Then scroll down to Parental Control PIN and press the OK key. The first time you select this option, you must enter the Default PIN number (4321). The next time you access this option, you can enter a new PIN number that is more meaningful to you. Remember the PIN you choose because you will use it to block and unblock TV programs or channels for viewing. Press the number keys on the remote control to enter your PIN number, and then press the OK key on the remote control.

Revert to Factory Settings

All of your setup choices will be erased if you choose the Revert to Factory Settings option.

Handling Disposable Batteries

- WARNING: There is danger of explosion if the battery is incorrectly inserted. Replace only with the same type of battery. Do not attempt to recharge it outside the system. Do not crush, puncture, dispose of in fire, short the external contacts, or expose to water or other liquids. Dispose of the battery in accordance with local regulations and instructions from your service provider.
WARNING: Avoid electric shock and fire hazard! Do not open the cover of this product. Opening or removing the cover may expose you to dangerous voltages. If you open the cover, your warranty will be void. This product contains no user-serviceable parts.
Service Warnings
WARNING: Avoid electric shock! Do not open the cover of this product. Opening or removing the cover may expose you to dangerous voltages. If you open the cover, your warranty will be void. This product contains no user-serviceable parts.
Check Product Warranty
Upon completion of any service or repair to this product, the service technician must perform safety checks to determine that the product is in proper operating condition.
Protect the Product When Moving It
Always disconnect the power source when moving the apparatus or connecting or disconnecting cables.
20090915_Cable_Safety

Enjoy crystal clear pictures and CD quality sound with your Cisco® 8389DVB Digital Video Recorder. Best of all, you can watch what you want to watch when you want to watch it at the press of a button. It's all described in this user guide. Go through it right away to learn about each feature and to help you enjoy your experience to the fullest.

Before using the set-top, read the Important Safety Instructions section of this guide.

Serial Number and MAC Address

Your service provider may ask for the serial number or the MAC address of the set-top if your system requires troubleshooting in the future. Look for the serial number and the MAC address on the bottom of the set-top.

Write the serial number here:
Write the MAC address here:

Manual Recording

- 1. Access the Recording Menu screen from the Main Menu.
2. Select Manual Recording from the Recording Menu screen.
3. Use the arrow keys to find a channel you want to record and to set the time to record it.
4. Press OK to save and exit when you have made all your selections.

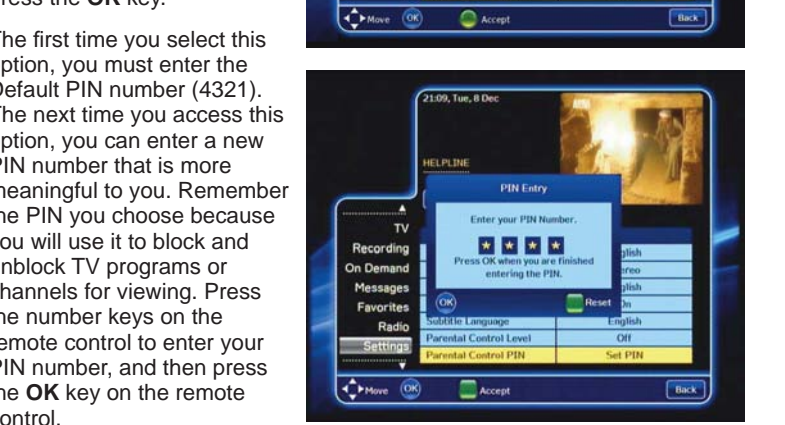

Recording Settings

The Recording Settings window enables you to set how to sort your programs in the Recording List and Scheduled List. You can sort the programs by channel, date, and time.



Electronic Program Guide

The Electronic Program Guide (EPG) displays channel program schedules for the current and future days. Use the arrow keys and the OK key on the remote control to scroll through the guide and select the program you want to view. Use the color-coded keys on the remote control to switch to a different Favorites list, see program schedules for the previous or next day, or set or remove reminder timers.

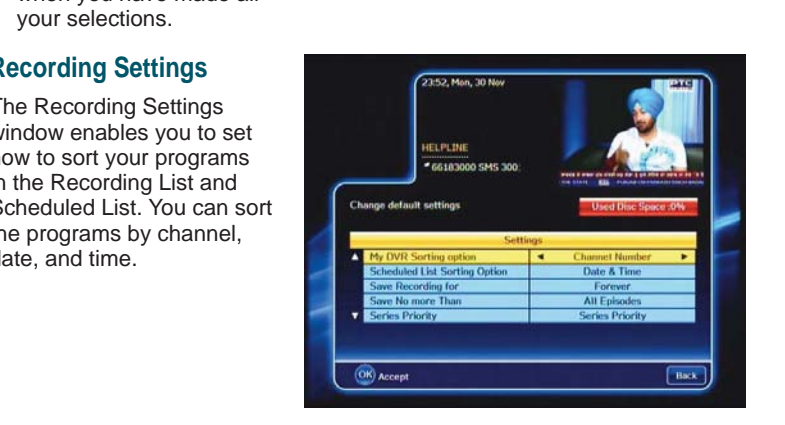

Record From the Program Guide

- 1. Press the GUIDE button.
2. Press the arrow buttons to select a program, and then press the RECORD button.
3. Choose your recording options and then press OK.
4. Review the recording you just set in the Scheduled List, press the HOME key to go to the Recording Menu, and then navigate to the Scheduled List.

Navigator Bar

The Navigator Bar displays information about current and future programs. To access the Navigator Bar, press the INFO key on the remote control.

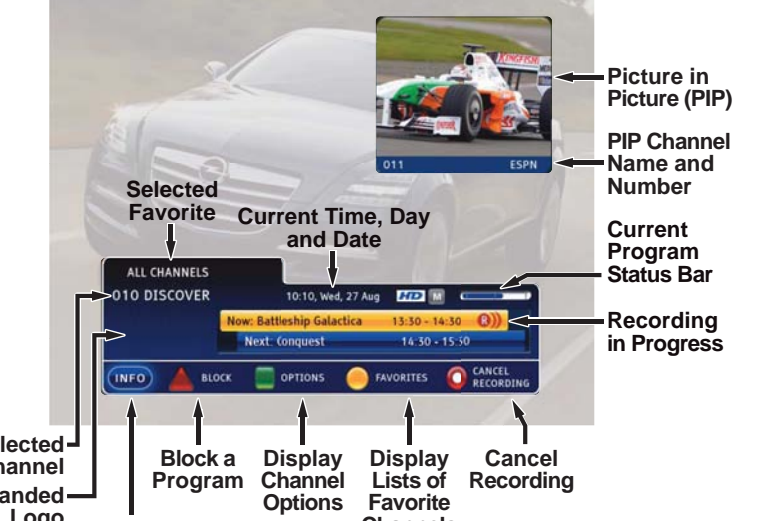

Color-Coded Options

The selection options at the bottom of the Navigator Bar (and on several other screens) are color-coded to match these four keys on your remote control. To access your selection, press the color-coded key on the remote control.

Note: When the Navigation Bar is not displayed, you can use the Red color-coded key to zoom (1x, 2x, 4x) the video on your TV.

About the Remote Control

- 1. Set-top remote control
2. TV mode control
3. Power On and Off
4. Access DVR recordings
5. Watch live TV
6. Pause recording
7. Fast-forward recording
8. Set a recording
9. Access the Main Menu
10. Obtain program information
11. Go to last channel or previous menu item
12. Page through the program guide
13. Scroll through menu items
14. Access color-coded screen options
15. Access ON DEMAND features
16. Scroll through channels
17. Select Favorite channels
18. Access specific channels
19. Access Picture-in-Picture (PIP) features
20. Mute volume
21. Adjust volume
22. Page through the program guide
23. Exit the guide and menus
24. Access the guide
25. Rewind recording
26. Play recording
27. Stop recording playback
28. Instant Replay (go back 7 seconds)

Front Panel

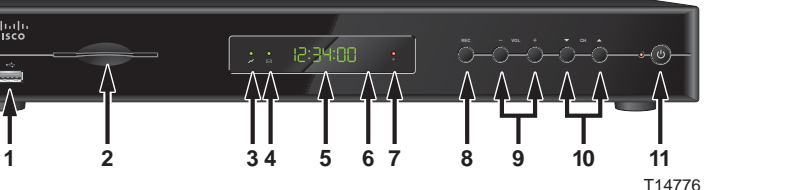

- 1 USB Port Reserved for future use
2 Smart Card Slot Reserved for future use
3 Arrows Indicates an active cable modem link
4 Envelope Indicates a message
5 Display Displays the selected channel number and time of day
6 IR Sensor Receives the infrared signal from the remote control. The sensor is behind the front panel
7 @ Illuminates to indicate a recording in progress
8 Record Press to enable an instant recording
9 Select: @ Illuminates to indicate a recording in progress
10 Vol-, Vol+ Adjusts volume
11 CH-, CH+ Scrolls through channels
12 Power Turns the set-top on and off

Main Menu

The Main Menu provides a menu of your favorite interactive services and popular channels. To access the Main Menu, press the HOME button on your remote control.

Guide: Displays the Program Guide, with all available channels and scheduled recordings.
TV: Programs are sorted by categories, as determined by your service provider.
Recording: Access recordings stored on the hard drive, view and modify future recordings and set manual recordings.
On Demand: Displays Games, Services, PPV, and Video On Demand (if offered by your service provider).
Messages: View messages and check what important announcements your service provider has for you.
Favorites: View and navigate through your lists of Favorites, making your experience more efficient and faster. This option also allows you to create your own lists.
Radio: Displays a list of audio channels.
Settings: Change various settings, such as languages, parental control options, and navigator type. Also allows you to revert to the factory settings for your set-top.
After you select an option, you can press Back to return to the Main Menu. Press Exit to leave the Main Menu.

View Blocked Channels

You will see the Channel Blocked window when you tune to a program that is blocked by Parental Control Rating. To unblock the program, press the Red key on the remote control, and then enter your four-digit Parental Control PIN in the PIN Entry window.

Set Blocking Options

- From the Navigator Bar, press the Red key to show the option to block.
The following options are available:
- Press the Red key to block the selected channel
- Press the Green key to block one or a list of channels
- Press the Yellow key to block one or a list of categories
- Press the Blue key to block a time slot
When tuned to a blocked channel, press the Red key and enter your PIN to unblock the program.

Program Information

To access program information, press the INFO key on the remote to bring up the navigation banner. The Info window displays detailed information about the program. Press the EXIT key to return to the navigation banner. Press the arrow keys to scroll to information about other programs.

Options

To access the Options window, press the INFO key on the remote control, and then press the color-coded key on the remote control for the channel options. The Options window displays selectable audio and video settings for the current channel.

Open Source GNU GPL Statement

Cisco 8389DVB set-top contains, in part, certain free/open source software ("Free Software") under licenses which generally make the source code available for free copy, modification, and redistribution. Examples of such licenses include all the licenses sponsored by the Free Software Foundation (e.g. GNU General Public License (GPL), GNU Lesser General Public License (LGPL), Berkeley Software Distribution (BSD), the MIT licenses and different versions of the Mozilla and Apache licenses). To find additional information regarding the Free Software, including a copy of the applicable license and related information, please go to: (i) for North America http://www.cisco.com/web/consumer/support/open_source.html, or (ii) for outside North America http://www.cisco.com/web/consumer/support/open_source.html-international. Once at the site, search for the product listing and click on the related items identified. If you have any questions or problems accessing any of the links, please contact: sp-rtg-external-open-source-requests@cisco.com.

Troubleshooting

If the set-top does not perform as expected, the following tips may help. If you need further assistance, contact your service provider.

No Picture

- Plug the TV and set-top into an electrical outlet that is not controlled by a wall switch.
- Verify that all cables are properly connected.
- Verify that the Power to the TV is turned on.
- Verify that the TV is set to the proper input channel.

No Color

- Verify that the current TV program is broadcast in color.
- Adjust the TV color controls.
- Verify that all audio and coaxial cables are properly connected.

No Sound

- Verify that the TV and set-top are properly connected to an electrical outlet.
- Verify that all cables are properly connected.
- Verify that the TV is set to the proper input channel.
- Verify that the volume is turned on.